

FILED

Date: 1-18-2018 By: JC

This survey consists of:

Map: _____

Narrative: _____

Corner Rpt: CS 65/99-24

DOUGLAS COUNTY
SURVEYOR

CORNER REPORT FORM

Section 21 Township 29 S Range 8W
Douglas County Date 10/2017
PLSS Number 300400

CORNER DESIGNATION

See Cor. 517/514
520/521

- Condition Report only
- Not Found
- Renewed
- Unrecorded
- Surveyed In
- Referenced out

Previous Renewals/Surveys, etc:

DCSO 1958 CS 49/100 K. DeGroot CS 63/52 M. 121-33
DCSO 1975 CS 57/39

Monument(s) & Accessories Found: (Condition and Source)

DCSO BRASS CAP
24" FIR N26°E 14' FT GOOD SCAR
28" W. FIR S76°E 30' FT " "
12" YEW N56°W 49' FT " "
36"x3' Rotted stump S28°E 27' No visible R/HZE
24"x3' Rotted stump S58°W 21' " " "

Monument Detail

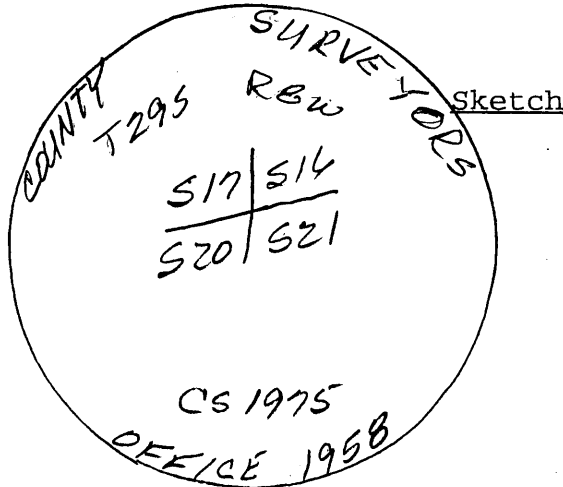

Monument Set (Procedures and Description)

New Accessories

29" FIR S58°W 42' FT scribed T29S R8W 520 BT

Location & Comments

Corner 13 @
S.E. Cor. of
CAMS Valley
Waste Site

Compass Declination 15 1/2° E
Firm/Agency: i.e. Engineering, Inc.
Address: 809 SE Pine St., Roseburg, OR 97470
Party Chief: N. From Dahl
Notes:
Witness: R. Heichel R. VINCENT

Surveyor's Seal

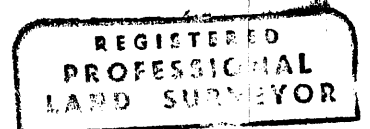

Ronald A. Quimby
ROBERT A. QUIMBY
1978
EXP 12-31-18

C.S. File 65/99-24