

FILED

Date: 1-18-2018 By: JC

This survey consists of:

Map: _____

Narrative: _____
Corner Rpt: CS 65/99-13

DOUGLAS COUNTY
SURVEYOR

CORNER REPORT FORM

Section 30 Township 30S Range 7W
Douglas County Date 10/2017
PLSS Number
100200

CORNER DESIGNATION

SEC COR 25/30
36/31

- Condition Report only
- Not Found
- Renewed
- Unrecorded
- Surveyed In
- Referenced out

Previous Renewals/Surveys, etc:

GLO SURVEY 1918 10/17 P9 9289 JOHNSTONE 1984 M 97-28
DCSO 1964 CS 53/40 SHAWER 2002 M 139-72 CS 65/42-4

Monument(s) & Accessories Found: (Condition and Source)

F 2 1/2 GLO BRASS CAP ON 1" I.P.
20" D. FIR S 85° E 26' FT GOOD SCAR (DEAD BURNT)
18" D. FIR N 59° E 22' FT GOOD SCAR
BURNT ROOT HOLE S 14° E 17' FT
BURNT ROOT HOLE S 79° W 62' FT

Monument Detail

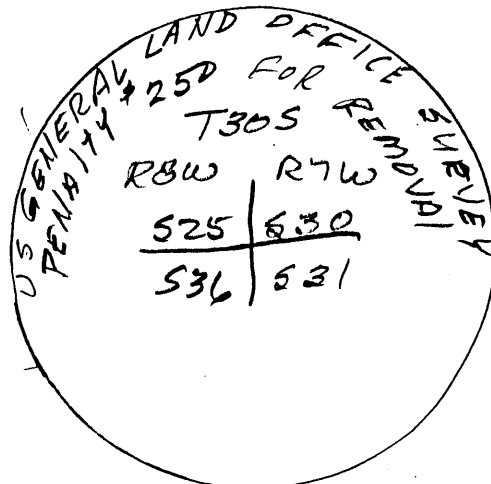

Sketch

ACCESSORIES

Monument Set (Procedures and Description)

5/8" I. ROD with yellow PLASTIC CAP N 16° W 25' FT
5/8" I. ROD with yellow PLASTIC CAP S 59° W 25' FT
set 5' ALUM POST along side I. ROD'S

New Accessories CAPS STAMPED ICE ENGINEERING

Surveyor's Seal

Location & Comments

CORNER IS APPROX
30' WEST OF SMALL
STREAM. AREA
BADLY BURNT
9/2017

Compass Declination 15 1/2° E
Firm/Agency: i.e. Engineering, Inc.
Address: 809 SE Pine St., Roseburg, OR 97470
Party Chief: J. LEONARD
Notes:
Witness: R. OLSEN

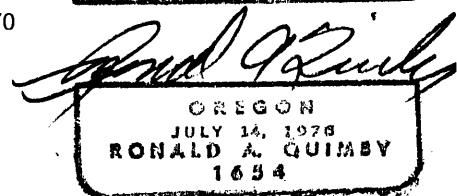
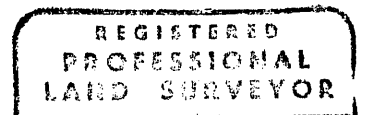

EXP 12-31-18

C.S. File 65/99-13