

BASIS OF BEARING PER RM1-66 (817.59')
S51° 55' 13"E 816.35'

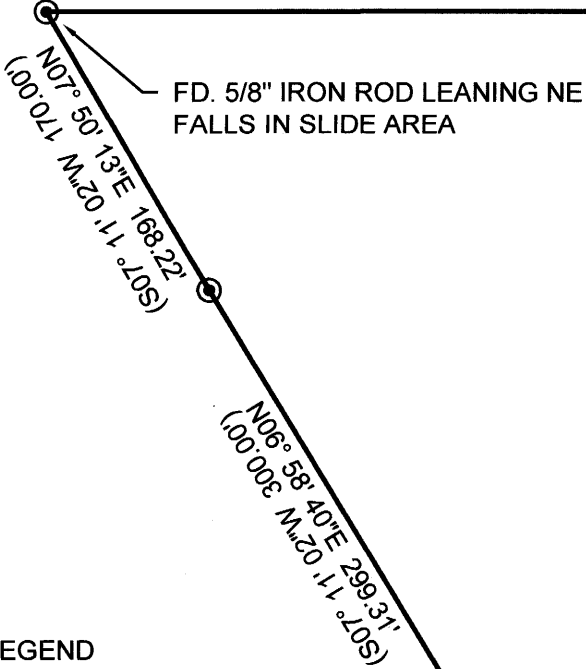

FD. 2 1/2" BRASS CAP
1/4 CORNER SEC 10 & 11
(PLSS 500540)
BEARS N 07°53'44" E
932.68'

LOT 21

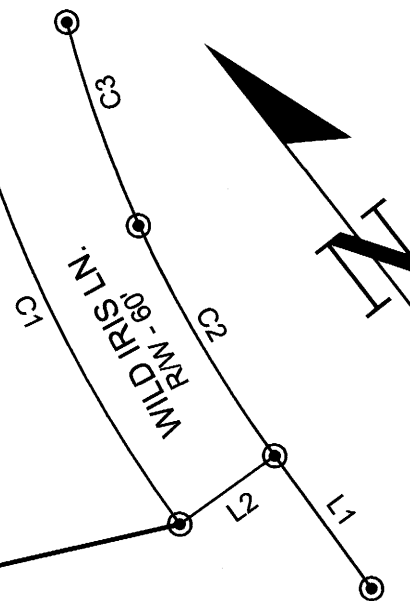

FILED
Date: 11-20-18 By: Di'
This survey consists of:
Map: C.S. 65/98-12
Narrative: _____
Corner Rpt: _____
**DOUGLAS COUNTY
SURVEYOR**

REGISTERED
PROFESSIONAL
LAND SURVEYOR

Mark A. Heimbarger

OREGON
JULY 16, 1987
MARK A. HEIMBURGER
2287

RENEWS JUNE 30, 2019

SCALE: 1" = 100'

LEGEND

- ⊙ FOUND 5/8" IRON ROD
- RESET 5/8"x30" IRON ROD WITH PLASTIC CAP MARKED "LAND MARK PLS2287"

RECORD INFORMATION
() RM1-66

Parcel Line Table			
Line #	Length	Direction	RECORD INFO
L1	85.47	N01° 54' 04"E	(N01°28'E 85.76')
L2	60.89	N87° 44' 16"W	(N88°32'W 60.00')

Curve Table					
Curve #	Length	Radius	Chord Direction	Chord Length	Record Info.
C1	270.81	730.00	S12° 27' 06"W	269.26	(CH. LENGTH 273.79')
C2	139.67	670.00	S7° 35' 11"W	139.42	(CH. LENGTH 143.84')
C3	112.44	670.00	S18° 21' 58"W	112.31	(CH. LENGTH 108.52')

NARRATIVE:

THE PURPOSE OF THE SURVEY WAS TO REFERENCE AN EXISTING MONUMENT THAT WAS TO BE DESTROYED DURING CONSTRUCTION.

THE EXISTING MONUMENT WAS TIED AND RESET AT THE ORIGINAL LOCATION.

EQUIPMENT: TRIMBLE S6 TOTAL STATION

FIELD: ANTHONY WELCH & BARTT HEICHEL

OFFICE: HEIMBURGER

RECORD OF SURVEY
In the
SE 1/4, Sec. 10 & SW 1/4 Sec. 11
T. 27 S., R. 05 W., W.M.
Douglas County, Oregon
Nov. 5, 2018

FOR: Chauncey Peltier
42638 NW Cedar Canyon Rd.
Banks, OR 97106
LM Proj. No. 2017-0057

Land Mark
SURVEYING INC.
3329 N.E. Stephens Street
Roseburg, Oregon 97470
Tel (541) 677-9400
Fax (541) 677-9401

Sheet 1 of 1

C.S. 65/98-12