

FILED

Date: 7-6-2017 By: Y

This survey consists of:

Map: \_\_\_\_\_

Narrative: \_\_\_\_\_

Corner Rpt: CS 65/95-40

DOUGLAS COUNTY  
SURVEYOR

CORNER REPORT FORM

Section 24 Township 25 S Range 2 W  
Douglas County Date 5/8/2017  
PLSS Number 700320

CORNER DESIGNATION

South 1/16 corner Section 24 only.

- Condition Report only
- Not Found
- Renewed
- Unrecorded
- Surveyed In
- Referenced out

Previous Renewals/Surveys, etc.:

Set by Hosford on M 16-5. ( cedar post )  
3/4" diam. iron pipe set by Williams/McChesney in 1975. See C.S. 59/11-8

Monument(s) & Accessories Found: (Condition and Source)

Found 1975 iron pipe. 3/4" diam.  
Hosford B.T.: 29" diam. Cedar stump w/partial scribe visible bears  
N. 10° W., 63.8' to "w" nail in face.  
1975 B.T.: A 41" diam. Fir stump w/partial scribe visible bears  
S. 85° W., 15.0' to "w" nail in face.

Monument Detail

Sketch

N/A

Monument Set (Procedures and Description)

N/A

New Accessories

A 9" diam. Hemlock bears S. 85° W., 46.5' . Both scribed "S 1/16 S24 BT"  
An 8" diam. Fir bears S. 30° W., 8.4'  
A six foot steel post is set 2 feet West.

Surveyor's Seal

Location & Comments

Compass Declination 15° East  
Firm/Agency: David Edwards Land Surveying  
Address: P.O. Box 361  
Oakland, Oregon 97462  
Party Chief: Brant Miller  
Notes: \_\_\_\_\_  
Witness: Eric Sprinkle

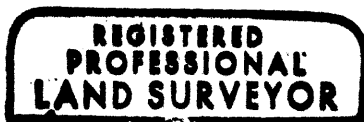

*David A. Edwards*



Renews 12/31/17

C.S. File 65/95-40