

FILED

Date: 3-29-2017 By: JC

This survey consists of:

Map: _____

Narrative: _____

Corner Rpt: CS 65/95-11

OREGON CORNER RESTORATION FORM

Section 2 Township 31S Range 3W

County Douglas Date 1-14-2016

DOUGLAS COUNTY
SURVEYOR

Corner Designation

S3 | S2
1/4 Corner

- Condition Report Only
- Not Found
- Renewed
- Unrecorded
- Surveyed In
- Referenced out

Previous Renewals / Surveys, etc.

Original by Bushey in 1893; renewed by Markham in 1959 and again by Douglas County in 1964 & 1977.

Monument (s) & Accessories Found: (Condition & Source)

Found 5/8" iron rod with aluminum cap in road ditch. Set by Douglas County survey crew in 1977.
25" Douglas Fir stump bears N62°W 412.34 feet. (scribed by Douglas County in 1964)
12" Broken Maple bears S29°W 29.50 feet. (scribed by Douglas County in 1977)

Monument Detail

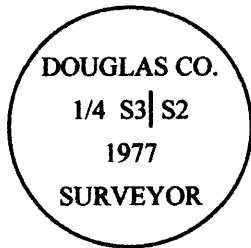

Sketch

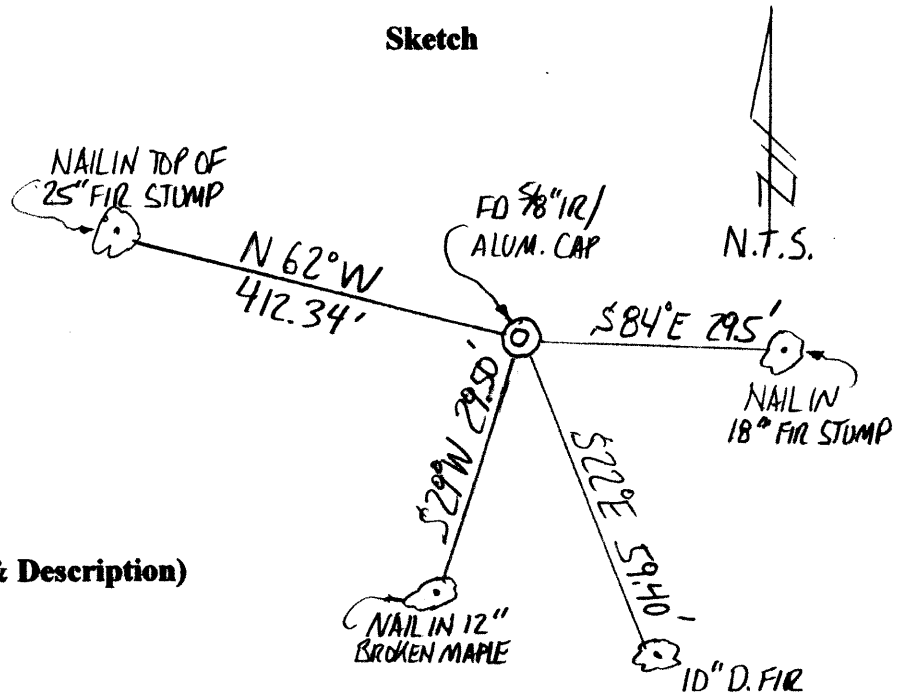

Monument Set (Procedures & Description)

N/A

New Accessories

Set steel post at corner.
18" Douglas Fir stump with nail in top bears S84°E 29.50 feet.
10" Douglas Fir bears S22°E 59.40 feet scribed "1/4 S2 BT".

Note: Set nail in the top of the existing 25" Douglas Fir stump which bears N62°W 412.34 feet; also set nail in the top of the broken 12" Maple which bears S29°W 29.50 feet.

Location & Comments:

Corner is in the ditch of an existing rock logging road.

Compass Declination N/A

Firm/Agency

Gregory D. Lang, Surveyor
7550 Willis Creek Rd.
Winston, Or 97496

Party Chief and Notes

Gregory Lang

Witness

Trevor Lang

Surveyor's Seal



EXPIRES: 12-31-2016

C.S. File No 65/95-11