

FILED

Date: 11/29/2016 By: JC

This survey consists of:

Map: \_\_\_\_\_

Narrative: \_\_\_\_\_  
Corner Rpt: CS 65/93-58

DOUGLAS COUNTY  
SURVEYOR

CORNER REPORT FORM

Section 26 Township 31S Range 6W  
Douglas County Date 11/17/16  
PLSS Number 600240

CORNER DESIGNATION

1/4 COR 26/25

- Condition Report only
- Not Found
- Renewed
- Unrecorded
- Surveyed In
- Referenced out

Previous Renewals/Surveys, etc:

DCSO 1961 CS 52/26 B. SHAPER 1995  
G. BAUGHMAN 196-32 BLM Dependent Resurvey 2004

Monument(s) & Accessories Found: (Condition and Source)

DCSO BRASS CAP  
A 20" CAPPED FIR STUMP N85 1/4 E 26 FT HEATED BLAZE  
A 25" Hemlock N90 E 130 FT HEATED BLAZE  
A 27" FIR N73 W 96 FT HEATED BLAZE

Monument Detail

Sketch

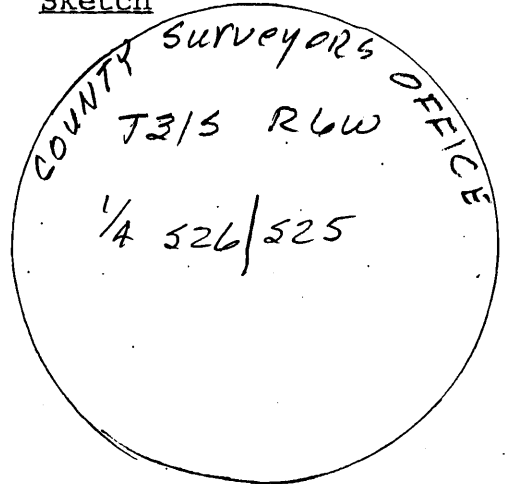

Monument Set (Procedures and Description)

New Accessories

1A" D. FIR S85 W 31 FT Scribed 1/4 526 BT

Surveyor's Seal

Location & Comments

Compass Declination 15 1/2 E  
Firm/Agency: i.e. Engineering, Inc.  
Address: 809 SE Pine St., Roseburg, OR 97470  
Party Chief: N. Fromdahl  
Notes: R. OLSON  
Witness:

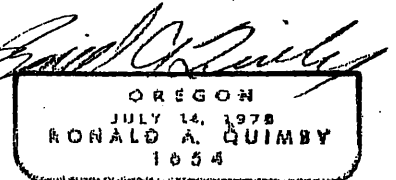
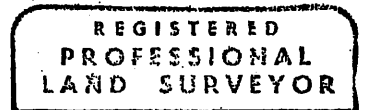

EXP 12-31-16

C.S. File 65/93-58