

FILED
 DATE: 11/23/2016 BY: J C
 THIS SURVEY CONSISTS OF:
 MAP: _____
 NARRATIVE: _____
 CORNER RPT: CS 65/93-55
 DOUGLAS COUNTY SURVEYOR

FS INDEX ID: V-17

CORNER INVESTIGATION REPORT

CORNER: SECTION **GCDB ID:** 500200 **DATE:** 9/13/2016
TOWNSHIP: 30 S **STATE:** OREGON
RANGE: 2 W **COUNTY:** DOUGLAS
SECTION: 26, 27, 34 & 35 **FOREST:** UMPQUA
MERIDIAN: W.M. **DISTRICT:** TILLER
NFSL PROPERTY BOUNDARY CORNER?: YES NO
LINE(S) POSTED: NORTH-1978 SOUTH-1978 EAST-1978 WEST-1978
MAINTAINED: NORTH-NONE SOUTH-2016 EAST-2016 WEST-NONE
GUARD POST(S): NORTH-5.3 FT WEST-2.3 FT EAST-3.9 FT

HISTORY OF VISITATIONS:
 1857 - DENNIS HATHORN, GLO SURVEY
 1968 - J. POWELL, ET. AL., CS 54/73
 1978 - G.S. BAUGHMAN, M65-56 & M65-78
 1982 - J. LANDRUM, ET. AL., CS 61/32
 1985 - L. MOFFIT, USFS CORNER CARD
 1990 - J. ARTMAN, USFS CORNER CARD
 1994 - G. LANG, M 120-69

CORNER HISTORY:

(1857) - ESTABLISHED CORNER, SET POST & 4 BT'S
 (1968) - FOUND 2 BT'S, SET IRON PIPE/BRASS CAP AND 3 NEW BT'S.
 (1978) - FOUND IRON PIPE/BRASS CAP & 5 BT'S.
 (1981) - FINDS IRON PIPE/BRASS CAP & 5 BT'S, MARKS 1 NEW BT.
 (1985) - FINDS IRON PIPE/BRASS CAP & 5 BT'S.
 (1990) - FINDS IRON PIPE/BRASS CAP & 6 BT'S. (1994) - FINDS BRASS CAP & 5 BT'S.

MONUMENT FOUND/SET:

FOUND A 1-1/4" GALVANIZED IRON PIPE WITH A 2-1/2" BRASS CAP, PROJECTING 13 INCHES ABOVE THE GROUND.

RECORD CORNER ACCESSORIES:

NO TRACE FOUND OF A (9" OAK)1857
 NO TRACE FOUND OF A (12" OAK)1857
 NO TRACE FOUND OF A (15" PINE)1857
 NO TRACE FOUND OF A (15" FIR)1857
 A 28" PINE BEARS, N5°23'W - 94.3 FT, WITH A HEALED SINGLE BLAZE.
 A ROOT HOLE BRS N0°48'E - 101.9 FT, AN INDETERMINATE SIZE FIR LOG LAYS SOUTHEAST WITH NO MARKS VISIBLE.
 A 20" FIR BEARS, S82°56'E - 74.2 FT, WITH A HEALED SINGLE BLAZE.
 A 24" FIR BEARS, N89°04'W - 132.4 FT, WITH A HEALED DOUBLE BLAZE.
 A ROOT HOLE BEARS, S89°55'W - 108.5 FT. A 23" PINE LOG LAYS SOUTH WITH A HEALED SINGLE BLAZE

NEW CORNER ACCESSORIES:

A 12" FIR BRS S29°28'W - 39.6 FT, MARKED "T30SR2WS34" "BT" ON A DOUBLE BLAZE.

 NEW BT'S INCLUDE A 3/4" BRASS WASHER MARKED "ORPLS#89396" NAILED IN THE LOWER BLAZE BETWEEN THE "B" & "T" SCRIBE.

CORNER MAINTENANCE/OTHER INFO:

CLEAR BRUSH FROM AROUND MONUMENT AND TO BT'S. TIE FLAGGING TO MONUMENT AND GUARD POSTS, PAINT BT FACES & A 6" BAND AT HEAD HEIGHT,

GEODETIC COORDINATES:

LATITUDE: N 42° 55' 52.727"
 LONGITUDE: W 122° 55' 21.337"
 ELLIPSOID HEIGHT:
 DATUM: NAD 83

DOCUMENTS ON FILE AT:

3106 PIERCE PARKWAY, STE. D
 SPRINGFIELD, OREGON 97477

SOURCE: POST PROCESSED RESOURCE GRADE, AS REPORTED BY JACK SNYDER.

DATE OF INVESTIGATION: 9/7/2016

REPORT BY: JONATHAN B. DREW II, PLS#89396, CFedS#1664

ASSISTED BY: ANDREW HILLMAN, SURVEY TECH.

JACOB HUNT, SURVEY TECH.

THIS DOCUMENT FILED IN CS OFFICE: YES

OTHER DOCUMENT FILED WITH CS: NONE

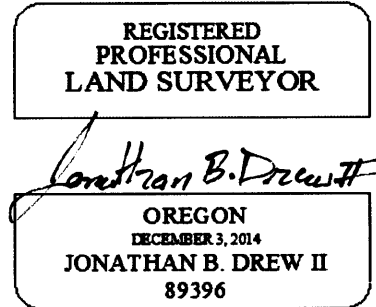

EXPIRES: 12/31/2017

RECORD MEASUREMENTS:

(N53°E - 72.6 FT)1857
 (S78°E - 176.2 FT)1857
 (S81°W - 285.8 FT)1857
 (N89°W - 351.8 FT)1857
 (N5°W - 94.1 FT)1968
 (N2°E - 103.0 FT)1968

 (S81°E - 74.4 FT)1968
 (N89°E - 132.5 FT)1982
 (S88°W - 108.6 FT)1982

METHOD OF MEASUREMENT:

LEICA 1103+ TOTAL STATION, BT'S MEASURED TO AN ALUMINUM NAIL SET AT SIDE CENTER, WITH BEARINGS TO CENTER. BEARING OF S89°17'14"E, PER M 65-56, HELD ON CENTER OF WOOD 4"x4" POST EAST OF CORNER, 133.8 FT TO WEST FACE.

CAP DIAGRAM:

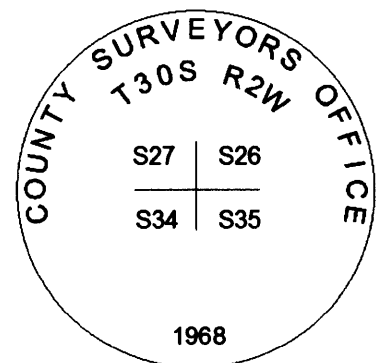

CS 65/93-55