

FILED  
DATE: 11-8-2016 BY: SC

THIS SURVEY CONSISTS OF:  
MAP: \_\_\_\_\_  
NARRATIVE: \_\_\_\_\_  
CORNER RPT: CS 65/93-43  
DOUGLAS COUNTY SURVEYOR

**FS INDEX ID:** Z-19 & A-19 **CORNER INVESTIGATION REPORT**

**CORNER:** 1/4 **GCDB ID:** 540100 & 540700 **DATE:** 9/13/2016  
**TOWNSHIP:** 30 & 31 S **STATE:** OREGON  
**RANGE:** 2 W **COUNTY:** DOUGLAS  
**SECTION:** 35 & 2 **FOREST:** UMPQUA  
**MERIDIAN:** W.M. **DISTRICT:** TILLER

**HISTORY OF VISITATIONS:**  
1857 - DENNIS HATHORN, GLO SURVEY  
1966 - J. POWELL, ET. AL., CS 54/28  
1978 - G.S. BAUGHMAN, M65-56 & M65-68

**NFSL PROPERTY BOUNDARY CORNER?:**  YES  NO

**LINE(S) POSTED:** NORTH-1978 EAST-1978  
**MAINTAINED:** NORTH-2016 EAST-2016  
**GUARD POST(S):** NORTH-3.2 FT EAST-2.1 FT

**CORNER HISTORY:**  
(1857) - ESTABLISHED CORNER, SET POST & 2 BT'S  
(1966) - FINDS 2 BT'S, SETS IRON PIPE/BRASS CAP & REMARKS ORIGINAL OAK BT.  
(1978) - FINDS IRON PIPE/BRASS CAP & 2 BT'S.

REGISTERED  
PROFESSIONAL  
LAND SURVEYOR

*Jonathan B. Drew II*  
OREGON  
DECEMBER 3, 2014  
JONATHAN B. DREW II  
89396

EXPIRES: 12/31/2017

**MONUMENT FOUND/SET:**  
FOUND A 1-1/4" GALVANIZED IRON PIPE WITH A 2-1/2" BRASS CAP, LEANING SLIGHTLY TO THE EAST AND PROJECTING 14 INCHES ABOVE THE GROUND.

**RECORD MEASUREMENTS:**  
(S30°E - 87.1 FT)1857  
(N75°E - 56.1 FT)1857, (N80°E)1966

**RECORD CORNER ACCESSORIES:**  
A 42" OAK WITH A HEALED SINGLE BLAZE.  
A 37" PINE WITH A HEALED SINGLE BLAZE.

**NEW CORNER ACCESSORIES:**  
NO NEW ACCESSORIES ADDED.

**METHOD OF MEASUREMENT:**  
NO NEW MEASUREMENTS TAKEN.

FILED AS CONDITION REPORT.

**CORNER MAINTENANCE/OTHER INFO:**  
CLEAR BRUSH FROM AROUND MONUMENT AND TO BT'S. TIE FLAGGING TO MONUMENT AND GUARD POSTS, PAINT BT FACES & A 6" BAND AT HEAD HEIGHT,

**CAP DIAGRAM:**

**GEODETIC COORDINATES:**  
**LATITUDE:**  
**LONGITUDE:**  
**ELLIPSOID HEIGHT:**  
**DATUM:**  
**SOURCE:**  
**DATE OF INVESTIGATION:** 08/30/16  
**REPORT BY:** ANDREW HILLMAN, SURVEY TECH.  
**ASSISTED BY:** JACOB HUNT, SURVEY TECH.

**DOCUMENTS ON FILE AT:**  
3106 PIERCE PARKWAY, STE. D  
SPRINGFIELD, OREGON 97477

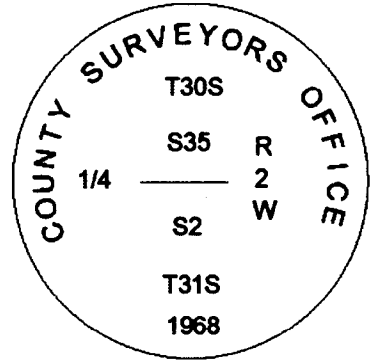

**THIS DOCUMENT FILED IN CS OFFICE:** YES  
**OTHER DOCUMENT FILED WITH CS:** NONE

C.S. File No 65/93-43