

FILED  
 DATE: 11-8-2016 BY: JC  
 THIS SURVEY CONSISTS OF:  
 MAP: \_\_\_\_\_  
 NARRATIVE: \_\_\_\_\_  
 CORNER RPT: CS 65/93-39  
 DOUGLAS COUNTY SURVEYOR

**CORNER INVESTIGATION REPORT**

FS INDEX ID: E-25 & E-1

**CORNER:** SECTION  
**TOWNSHIP:** 31 S  
**RANGE:** 2W & 1W  
**SECTION:** 1, 12 & 6, 7  
**MERIDIAN:** W.M.  
**GCDB ID:** 700600 & 100600 **DATE:** 9/13/2016  
**STATE:** OREGON  
**COUNTY:** DOUGLAS  
**FOREST:** UMPQUA  
**DISTRICT:** TILLER

**HISTORY OF VISITATIONS:**

1857 - DENNIS HATHORN, GLO SURVEY  
 1889 - W. BRIGGS, V.01-PG.137  
 1967 - G.S. BAUGHMAN, M 34-23, CS55/41  
 1978 - G.S. BAUGHMAN, M 65-79  
 1980 - L. HERZSTEIN, USFS CORNER CARD  
 2003 - L. HERZSTEIN, BLM RESURVEY

**NFSL PROPERTY BOUNDARY CORNER?:**  YES  NO

**LINE(S) POSTED:** EAST-1967 SOUTH-1967  
**MAINTAINED:** EAST-2016 SOUTH-2016  
**GUARD POST(S):** EAST - 2.7 FT

**CORNER HISTORY:**

(1857) - ESTABLISHED CORNER, SETS POST & 4 BT'S.  
 (1889) - "ORIGINAL BT STILL STANDING" NO NOTE OF MONUMENT FOUND OR SET.  
 (1967) - SETS BRASS CAP/IRON PIPE BY SINGLE PROPORTION, MARKS 4 NEW BT'S.  
 (1978) & (1980) - FINDS BRASS CAP/IRON PIPE AND 4 BT'S.  
 (2003) - FINDS BRASS CAP/IRON PIPE WITH 4 BT'S, MARKS 2 NEW BT'S.

**MONUMENT FOUND/SET:**

FOUND A 2-1/2" GALVANIZED IRON PIPE WITH A 2-1/2" BRASS CAP, PROJECTING 10 INCHES ABOVE A MOUND OF STONE. LEANS SLIGHTLY WEST.

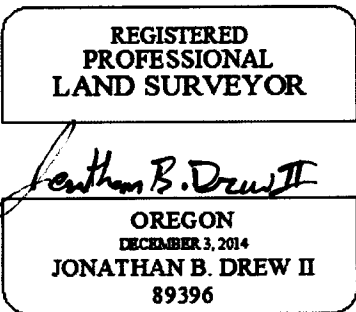

EXPIRES: 12/31/2017

**RECORD CORNER ACCESSORIES:**

NO TRACE FOUND OF A (10" OAK)1857  
 NO TRACE FOUND OF A (12" OAK)1857  
 NO TRACE FOUND OF A (9" OAK)1857  
 NO TRACE FOUND OF A (24" PINE)1857  
 A 12" FIR SNAG WITH SCRIBE VISIBLE ON A ROTTED FACE.  
 A 12" FIR SNAG WITH A HEALED SINGLE BLAZE.  
 A 26" PINE WITH A HEALED SINGLE BLAZE.  
 A 21" CEDAR WITH A HEALED SINGLE BLAZE.  
 A 15" PINE WITH A HEALED DOUBLE BLAZE.  
 A 11" OAK WITH A HEALED SINGLE BLAZE.  
 A 1" IRON ROD BY PERSONS UNKNOWN, PROJECTING 8" ABOVE THE GROUND.

**RECORD MEASUREMENTS:**

(N14°W - 66.0 FT)1857  
 (N28°E - 23.8 FT)1857  
 (S18°W - 52.1 FT)1857  
 (S68°E - 32.3 FT)1857  
 (N14°30'E-51.7')1967,(N10°15'E-51.0')2003  
 (S86°E-35.6')1967,(S88°45'E-35.9')2003  
 (N54°W-1.7')1967,(N36°15'W-1.9')2003  
 (S34°30'W-15.9 FT)1967,(S33°15'W)2003  
 (N59°45'E - 111.2 FT)2003  
 (S59°30'E - 31.3 FT)2003  
 (S50°35'E - 126.59 FT)2003

**NEW CORNER ACCESSORIES:**

NO NEW ACCESSOIRES ADDED.

**METHOD OF MEASUREMENT:**

NO NEW MEASUREMENTS TAKEN.

FILED AS CONDITION REPORT.

**CORNER MAINTENANCE/OTHER INFO:**

CLEAR BRUSH FROM AROUND MONUMENT AND TO BT'S. TIE FLAGGING TO MONUMENT AND GUARD POSTS, PAINT BT FACES & A 6" BAND AT HEAD HEIGHT,

**GEODETIC COORDINATES:**

**LATITUDE:** N 42° 54' 06.576"  
**LONGITUDE:** W 122° 52' 58.962"  
**ELLIPSOID HEIGHT:**

**DOCUMENTS ON FILE AT:**

3106 PIERCE PARKWAY, STE. D  
 SPRINGFIELD, OREGON 97477

**DATUM:** NAD83

**SOURCE:** POST PROCESSED RESOURCE GRADE, AS REPORTED BY JACK SNYDER.

**DATE OF INVESTIGATION:** 08/15/2016

**REPORT BY:** JONATHAN B. DREW II, PLS#89396, CFedS#1664

**ASSISTED BY:** ANDREW HILLMAN, SURVEY TECH.  
 JACOB HUNT, SURVEY TECH.

**THIS DOCUMENT FILED IN CS OFFICE:** YES  
**OTHER DOCUMENT FILED WITH CS:** NONE

**CAP DIAGRAM:**

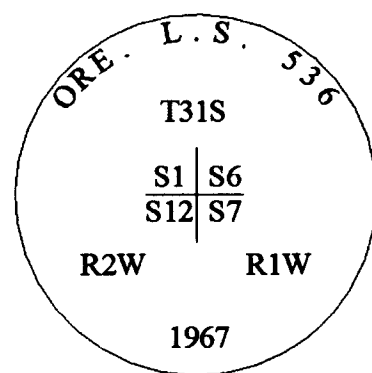

C.S. File No 65/93-39