

FS INDEX ID: E-5

# CORNER INVESTIGATION REPORT

**CORNER:** SECTION  
**TOWNSHIP:** 20 S  
**RANGE:** 11 W  
**SECTION:** 5, 6, 7 & 8  
**MERIDIAN:** W.M.  
**GCDB ID:** 200600  
**STATE:** OREGON  
**COUNTY:** DOUGLAS  
**FOREST:** SIUSLAW  
**DISTRICT:** CENTRAL COAST  
**NFSL PROPERTY BOUNDARY CORNER?:**  YES  NO

**DATE:** 11/12/2015

**HISTORY OF VISITATIONS:**

1891-W.M. THIEL, GLO SURVEY  
 1970-VERNON TRACY ET AL., CS 53/66  
 1982-GERALD K ATTIG, M91-20  
 1983-LES ROBERTS, M90-50  
 1987-DANIEL W. BAKER, M105-40  
 1988-DANIEL W. BAKER, M106-67  
 2002-HARVEY CHRISTENSEN, M149-39

**LINE(S) POSTED:** SOUTH-2015 EAST-1982  
**MAINTAINED:** SOUTH-NONE EAST-NONE  
**GUARD POST(S):** SOUTH-NONE EAST-3.5 FT

**CORNER HISTORY:**

(1891)-ESTABLISHED SECTION CORNER. SETS POST & 4 BT'S.  
 (1970)-FINDS 3 BT'S. SETS BRASS CAP/IRON PIPE & 2 NEW BT'S.  
 (1982)-FINDS BRASS CAP/IRON PIPE & 5 BT'S. SETS 2 NEW BT'S.  
 (1983)&(1987)&(1988)-FINDS BRASS CAP/IRON PIPE & 7 BT'S.  
 (2002)-FINDS BRASS CAP/IRON PIPE & BT'S PER M105-40.

**MONUMENT FOUND/SET:**

FOUND A 2-1/2" BRASS CAP ON A 1-1/4" GALVANIZED IRON PIPE. PROJECTING 16 INCHES ABOVE THE GROUND.

REGISTERED  
 PROFESSIONAL  
 LAND SURVEYOR

*Jonathan B. Drew II*

OREGON  
 DECEMBER 3, 2014  
 JONATHAN B. DREW II  
 89396

EXPIRES: 12/31/2015

**RECORD MEASUREMENTS:**

(N69°30'E-13.9')1891, (N71°E-13.8')1988

(S16°E-6.6 FT)1891 & 1988

(S43°W-8.6 FT)1891, (8.8 ft)1988

(N30°30'W-25.7 FT)1891

(N48°E-28.8 FT)1970, (28.4 FT)1988

(N23°W-36.0')1970, (N24°W-35.3')1988

(S86°W-22.6')1982, (N88°W-22.5')1988

(S61°E-13.3 FT)1982, (S60°E)1988

**METHOD OF MEASUREMENT:**

BEARINGS BASED ON TRAVERSE  
 TIE SOUTH TO 1/4 S7 & S8, BEING  
 S0°19'02"W. PER DCSO M91-20.

EQUIPMENT: LEICA 1203+ TOTAL  
 STATION. BEARINGS TO CENTER  
 DISTANCES TO ALUMINUM NAIL  
 SET AT SIDE CENTER.

**CAP DIAGRAM:**

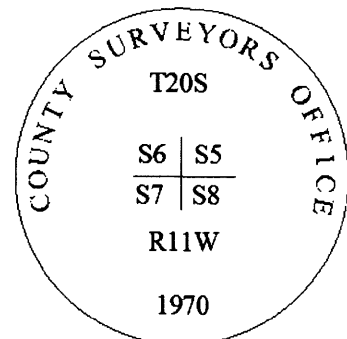

**RECORD CORNER ACCESSORIES:**

AN INDETERMINATE SIZE FIR STUB BEARS. N71°30'E - 13.9 FT, WITH NO MARKS VISIBLE ON A PREVIOUSLY OPENED SINGLE BLAZE.  
 AN INDETERMINATE SIZE FIR STUMP BEARS. S10°30'E - 6.4 FT, WITH NO MARKS VISIBLE ON A PREVIOUSLY OPENED SINGLE BLAZE.  
 A 36" FIR STUMP BEARS. S44°45'W - 8.2 FT, WITH NO MARKS VISIBLE ON A PREVIOUSLY OPENED SINGLE BLAZE.  
 NO TRACE FOUND OF A (6" ALDER)1891  
 A 52" SPRUCE BEARS. N48°30'E - 29.0 FT, WITH NO VISIBLE FACE.  
 AN INDETERMINATE SIZE ALDER STUB BEARS. N24°W - 36.4 FT, WITH NO MARKS.  
 A 11" ALDER BEARS. N88°W - 22.6 FT, WITH BARK SCRIBE "T20S R11W NE SEC S7 BT"  
 A 9" ALDER BEARS. S60°E - 12.8 FT, WITH BARK SCRIBE "T20S R11W NW SEC S8 BT"

**NEW CORNER ACCESSORIES:**

A 10" ALDER BEARS. N24°W - 22.5 FT, BARK SCRIBED "T20SR11WS6BT"  
 INCLUDES 3/4" BRASS WASHER MARKED "ORPLS #89396" NAILED BETWEEN "B" & "T" SCRIBE.

**CORNER MAINTENANCE/OTHER INFO:**

CLEAR BRUSH FROM AROUND MONUMENT AND TO BT'S. TIE FLAGGING TO MONUMENT AND GUARD POSTS. PAINT BT FACES & A 6" BAND AT HEAD HEIGHT. ADD NEW NAILS TO EXISTING BT TAGS & ADD NEW TAGS WHERE NEEDED. TRUE LINE POSTED WITH PROPERTY BOUNDARY SIGNS ATTACHED TO ALUMINUM POSTS FROM THIS CORNER TO 1/4 CORNER S7&S8. SEE CS SURVEY TO BE FILED.

**GEODETIC COORDINATES:**

LATITUDE: N 43° 51' 17.644"  
 LONGITUDE: W 124° 02' 46.531"  
 ELLIPSOID HEIGHT:

**DOCUMENTS ON FILE AT:**

3106 PIERCE PARKWAY, STE. D  
 SPRINGFIELD, OREGON 97477

DATUM: WGS 84

SOURCE: CELL PHONE GPS. FOR NAVIGATION TO CORNER.

**DATE OF INVESTIGATION:** 11/3/2015

**REPORT BY:** JONATHAN B. DREW II, PLS#89396, CFedS#1664

**ASSISTED BY:** ANDREW HILLMAN, SURVEY TECH.

**THIS DOCUMENT FILED IN CS OFFICE:** YES  
**OTHER DOCUMENT FILED WITH CS:** CS SURVEY