

FS INDEX ID: P-11

CORNER INVESTIGATION REPORT

CORNER: C 1/4
TOWNSHIP: 31 S
RANGE: 1 W
SECTION: 21
MERIDIAN: W.M.
NFSL PROPERTY BOUNDARY CORNER?: YES NO

GCDB ID: 340340
STATE: OREGON
COUNTY: DOUGLAS
FOREST: UMPQUA
DISTRICT: TILLER

DATE: 6/17/2015

HISTORY OF VISITATIONS:

1978-G.S. BAUGHMAN, M70-28
 1985-L.R. MOFFIT, USFS CORNER CARD
 2013-J. RANSOM/J. DREW II, CS 65/85-17

LINE(S) POSTED: WEST-1978 SOUTH-1978
MAINTAINED: WEST-2015 SOUTH-2013
GUARD POST(S): WEST SOUTH

CORNER HISTORY:

(1978)-ESTABLISHES C 1/4 SECTION 21, SETS BRASS CAP/IRON PIPE & 2 BT'S.
 (1985)-FINDS BRASS CAP/IRON PIPE & 2 BT'S.
 (2013)-FINDS BRASS CAP/IRON PIPE & 2 BT'S. PIPE FOUND LEANING & LOOSE.
 STRAIGHTEN PIPE & RE-PACK STONE.

MONUMENT FOUND/SET:

FOUND A 3" BRASS CAP ON 2-1/2" GALVANIZED IRON PIPE, PROJECTING 15 INCHES ABOVE A MOUND OF STONE.

RECORD CORNER ACCESSORIES:

A 22" FIR WITH A HEALED DOUBLE BLAZE.
 A 20" FIR WITH A HEALED DOUBLE BLAZE.

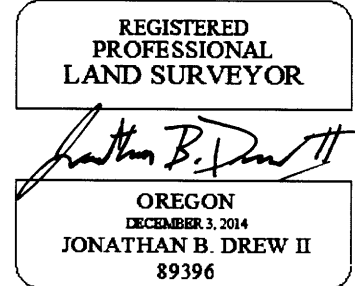

EXPIRES: 12/31/2015
RECORD MEASUREMENTS:

(S45°W - 9.4 FT)1978
 (N34°E - 8.9 FT)1978

FILED

Date: 8/25/2015 By: JC
 This survey consists of:
Map: _____
Narrative: _____
Corner Rpt: CS 65/90-56

DOUGLAS COUNTY SURVEYOR

NEW CORNER ACCESSORIES:

NO NEW ACCESSORIES ADDED.

METHOD OF MEASUREMENT:

NO NEW MEASUREMENTS TAKEN.
 GUARD POSTS PRESENT, NOT MEASURED.

FILED AS CONDITION REPORT.

CORNER MAINTENANCE/OTHER INFO:

CLEAR BRUSH FROM AROUND MONUMENT AND TO BT'S. TIE FLAGGING TO MONUMENT AND GUARD POSTS, PAINT BT FACES & A 6" BAND AT HEAD HEIGHT, ADD NEW NAILS TO EXISTING BT TAGS & ADD NEW TAGS WHERE NEEDED.

GEODETTIC COORDINATES:

LATITUDE: N 42° 51' 54.877"
LONGITUDE: W 122° 50' 01.183"
ELLIPSOID HEIGHT: 3265 FT
DATUM: WGS 84

DOCUMENTS ON FILE AT:

3106 PIERCE PARKWAY, STE. D
 SPRINGFIELD, OREGON 97477

SOURCE: USGS QUAD MAP. FOR NAVIGATION TO CORNER.

DATE OF INVESTIGATION: 6/11/2015

REPORT BY: JONATHAN B. DREW II, PLS#89396, CFedS#1664

ASSISTED BY: ANDREW HILLMAN, SURVEY TECH.

THIS DOCUMENT FILED IN CS OFFICE: YES

OTHER DOCUMENT FILED WITH CS: NONE

CAP DIAGRAM:

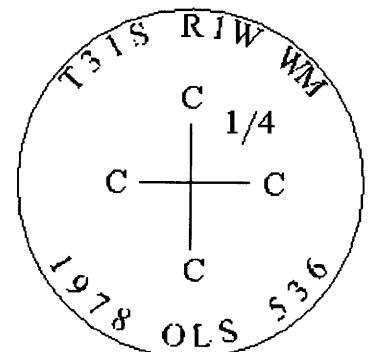

C.S. File No 65/90-56