

FS INDEX ID: J-5

CORNER INVESTIGATION REPORT

CORNER: SECTION GCDB ID: 200500 DATE: 6/9/2015
TOWNSHIP: 32S STATE: OREGON
RANGE: 1W COUNTY: DOUGLAS
SECTION: 7, 8, 17 & 18 FOREST: UMPQUA
MERIDIAN: W.M. DISTRICT: TILLER
NFSL PROPERTY BOUNDARY CORNER?: [x] YES [] NO
LINE(S) POSTED: EAST-1979 WEST-1979 NORTH-1980 SOUTH-1980
MAINTAINED: EAST-2015 WEST-2015 NORTH-1989 SOUTH-1989
GUARD POST(S): EAST-5.1 FT WEST-5.0 FT NORTH-2.4 FT SOUTH-29.5 FT
CORNER HISTORY:

HISTORY OF VISITATIONS:
1883-R.S. MOORE, GLO SURVEY
1968-J.M. POWELL ET. AL, CS 54/71
1979-K.O. DeGROOT, USFS CORNER CARD
1980-B.A. SHANER, M79-67 & M79-68
1986-L.R. MOFFIT, USFS CORNER CARD

(1883)-ESTABLISHED SECTION CORNER, SETS POST & 4 BT'S.
(1968)-FINDS 4 BT'S, SETS BRASS CAP/IRON PIPE & 3 BT'S.
(1979)-FINDS BRASS CAP/IRON PIPE & 7 BT'S.
(1980)-FINDS BRASS CAP/IRON PIPE & 7 BT'S.
(1986)-FINDS BRASS CAP/IRON PIPE & 7 BT'S.
MONUMENT FOUND/SET:
FOUND A 2-1/2" BRASS CAP ON 1-1/4" GALVANIZED IRON PIPE, PROJECTING 13 INCHES ABOVE THE GROUND.

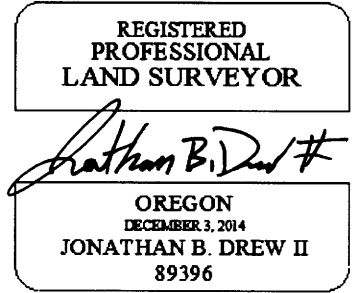

RECORD CORNER ACCESSORIES:
A 21" MADRONE WITH NO VISIBLE FACE, LEANS HEAVY WEST.
ROTTEN REMAINS OF A MADRONE. NO MARKS, 9" MADRONE SHOOT GROWS FROM SOUTH SIDE OF REMAINS OF OLD MAIN ROOT CROWN.
A 14" FIR SNAG WITH A HEALED DOUBLE BLAZE.
AN INDETERMINATE SIZE FIR STUB WITH NO MARKS VISIBLE.
A 10" LIVE OAK WITH A HEALED DOUBLE BLAZE.
A 35" CEDAR WITH A HEALED DOUBLE BLAZE.
A 19" MADRONE WITH A HEALED SINGLE BLAZE, LEANS HEAVY NORTHWEST.

EXPIRES: 12/31/2015
RECORD MEASUREMENTS:
(N16°E - 19.8 FT)1883
(S67°E-17.2')1883, (S61°E-16.2')1980
(S51°W-18.5')1883, (S56°W-21.6')1980
(N46°W - 11.2 FT)1883
(S44°W - 12.1 FT)1968
(N58°W - 15.0 FT)1968
(S40°E - 40.2 FT)1968

NEW CORNER ACCESSORIES:
NO NEW ACCESSORIES ADDED.

METHOD OF MEASUREMENT:
NO NEW MEASUREMENTS TAKEN.

CORNER MAINTENANCE/OTHER INFO:
CLEAR BRUSH FROM AROUND MONUMENT AND TO BT'S. TIE FLAGGING TO MONUMENT AND GUARD POSTS, PAINT BT FACES & A 6" BAND AT HEAD HEIGHT, ADD NEW NAILS TO EXISTING BT TAGS & ADD NEW TAGS WHERE NEEDED.

FILED AS CONDITION REPORT.

GEODETIC COORDINATES:
LATITUDE: N 42° 47' 43.262"
LONGITUDE: W 122° 51' 13.277"
ELLIPSOID HEIGHT: 2745 FT
DATUM: WGS 84
SOURCE: USGS QUAD MAP, FOR NAVIGATION TO CORNER.
DATE OF INVESTIGATION: 6/3/2015
REPORT BY: JONATHAN B. DREW II, PLS#89396, CFedS#1664
ASSISTED BY: ANDREW HILLMAN, SURVEY TECH.

DOCUMENTS ON FILE AT:
3106 PIERCE PARKWAY, STE. D
SPRINGFIELD, OREGON 97477

CAP DIAGRAM:

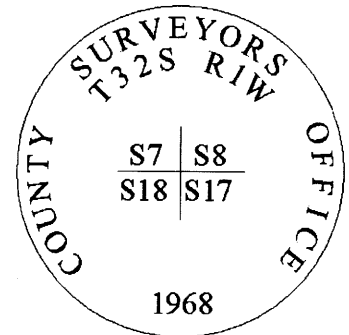

THIS DOCUMENT FILED IN CS OFFICE: YES
OTHER DOCUMENT FILED WITH CS: NONE

C.S. File No 65/90-53