

FS INDEX ID: E-21

CORNER INVESTIGATION REPORT

CORNER: SECTION GCDB ID: 600600 DATE: 7/2/2015
TOWNSHIP: 31S STATE: OREGON
RANGE: 2W COUNTY: DOUGLAS
SECTION: 1, 2, 11 & 12 FOREST: UMPQUA
MERIDIAN: W.M. DISTRICT: TILLER
NFSL PROPERTY BOUNDARY CORNER?: [X] YES [ ] NO
LINE(S) POSTED: NORTH-1978 EAST-1978
MAINTAINED: NORTH-2015 EAST-2015
GUARD POST(S): NORTH-3.4 FT EAST-3.1 FT
CORNER HISTORY:

(1857)-ESTABLISHED SECTION CORNER, SETS POST & 4 BT'S.
(1960)-FINDS 2 BT'S, SETS TRUCK AXLE & 4 BT'S.
(1966)-FINDS TRUCK AXLE & 4 BT'S, SETS 1 BT. (1978)-FINDS CORNER PER CS 61/6-30, SHOWS CAP MARKED 1978 NOT 1980. (1980)-FINDS TRUCK AXLE & 5 BT'S, SETS BRASS CAP/IRON PIPE IN PLACE OF AXLE. (2008)-FINDS CORNER PER M65-68.

MONUMENT FOUND/SET:

FOUND A 2-1/2" BRASS CAP ON 1-1/4" GALVANIZED IRON PIPE, PROJECTING 2 INCHES ABOVE A MOUND OF STONE.

RECORD CORNER ACCESSORIES:

NO TRACE FOUND OF A (18" OAK)1857
NO TRACE FOUND OF A (18" OAK)1857
A 19" OAK SNAG BEARS. N68°30'E - 26.6 FT, WITH SCRIBE VISIBLE ON A PARTIALLY HEALED DOUBLE BLAZE.
NO TRACE FOUND OF A (18" OAK)1857
A 14" FIR STUMP BEARS. N79°E - 25.6 FT, WITH A HEALED SINGLE BLAZE.
NO TRACE FOUND OF A (14" CEDAR)1960
A 19" CEDAR BEARS. S54°30'W - 36.9 FT, WITH SCRIBE VISIBLE ON A PARTIALLY HEALED SINGLE BLAZE.
NO TRACE FOUND OF A (8" FIR)1960
A 15" FIR BEARS. N68°30'W - 12.9 FT, WITH A HEALED DOUBLE BLAZE.

NEW CORNER ACCESSORIES:

A 5/8" REBAR BEARS. S41°00'E - 7.63 FT, WITH A 2" ALUMINUM CAP MARKED "RM PLS 89396 2015" AND CENTER PUNCH.
A 14" CEDAR BEARS. N82°45'E - 26.0 FT, MARKED "T31SR2WS1""BT" ON A DOUBLE BLAZE.

CORNER MAINTENANCE/OTHER INFO:

CLEAR BRUSH FROM AROUND MONUMENT AND TO BT'S. TIE FLAGGING TO MONUMENT AND GUARD POSTS, PAINT BT FACES & A 6" BAND AT HEAD HEIGHT, ADD NEW NAILS TO EXISTING BT TAGS & ADD NEW TAGS WHERE NEEDED. NEW BT INCLUDES A 3/4" BRASS WASHER "ORPLS#89396" NAILED BETWEEN B & T.

GEODETIC COORDINATES:

LATITUDE: N 42° 54' 06.396"
LONGITUDE: W 122° 54' 10.047"
ELLIPSOID HEIGHT: 1905 FT
DATUM: WGS 84

DOCUMENTS ON FILE AT:

3106 PIERCE PARKWAY, STE. D
SPRINGFIELD, OREGON 97477

SOURCE: CELL PHONE GPS, FOR NAVIGATION TO CORNER.

DATE OF INVESTIGATION: 6/18/2015

REPORT BY: JONATHAN B. DREW II, PLS#89396, CFedS#1664

ASSISTED BY: ANDREW HILLMAN, SURVEY TECH.

HISTORY OF VISITATIONS:

1857-DENNIS HATHORN, GLO SURVEY
1960-JOHN H. MARKHAM, CS 42/392
1966-JOHN M. POWELL ET. AL, CS 54/28
1978-G.S.BAUGHMAN, M65-68, & M65-79
1980-D. GAYLORD ET.AL, CS 61/6-30
2008-DAVE BEEDLE, M156-46

REGISTERED PROFESSIONAL LAND SURVEYOR

Jonathan B. Drew II

OREGON DECEMBER 3, 2014 JONATHAN B. DREW II 89396

EXPIRES: 12/31/2015

RECORD MEASUREMENTS:

(S13°W - 46.2 FT)1857
(N64°W - 18.5 FT)1857
(N72°E - 27.1 FT)1857

(S54°E - 39.6 FT)1857
(N80°E - 25.6 FT)1960
(S55°E - 20.5 FT)1960
(S55°W - 36.6 FT)1960

(N34°W - 27.2 FT)1960
(N67°W - 13.6 FT)1966

METHOD OF MEASUREMENT:

LEICA TCRA 1103+ TOTAL STATION, HOLD S89°53'27"E ON STEEL POST FOUND 290.9 FT EAST FROM CORNER BEARINGS TO CENTER, DISTANCES TO NAIL SET SIDE CENTER. BEARINGS TO BT'S TO NEAREST 1/4° BEARINGS TO RM TO NEAREST 1'.

CAP DIAGRAM:

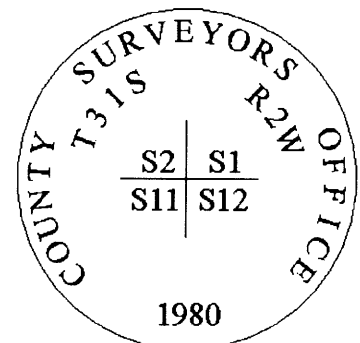

THIS DOCUMENT FILED IN CS OFFICE:

YES

OTHER DOCUMENT FILED WITH CS:

NONE

C.S. File No 65/90-50