

FS INDEX ID: E-19

CORNER INVESTIGATION REPORT

CORNER: 1/4 GCDB ID: 540600 DATE: 7/7/2015
TOWNSHIP: 31S STATE: OREGON
RANGE: 2W COUNTY: DOUGLAS
SECTION: 2 & 11 FOREST: UMPQUA
MERIDIAN: W.M. DISTRICT: TILLER
NFSL PROPERTY BOUNDARY CORNER?: [X] YES [] NO
LINE(S) POSTED: NORTH-1978 WEST-1978
MAINTAINED: NORTH-2008 WEST-2015
GUARD POST(S): NORTH-2.6 FT WEST-2.0 FT
CORNER HISTORY:

HISTORY OF VISITATIONS:
1857-DENNIS HATHORN, GLO SURVEY
1928-H.L. EPPSTEIN ET. AL, V.3 Pg.287
1966-JOHN M. POWELL ET. AL, CS 54/28
1978-G.S. BAUGHMAN, M65-68
1980-B.A. SHANER, RM3-27 & M81-71A
2008-R.D. ROMEO, CS 65/63-31
2008*-DAVE BEEDLE, M156-46
2009-DAVE BEEDLE, PART#2009-0059

(1857)-ESTABLISHED 1/4 CORNER, MARKS 8" PINE CORNER TREE & 2 BT'S.
(1928)-FINDS CORNER TREE & 1 BT, SETS POST & 2 BT'S. (1966)-FINDS 2 BT'S, SETS BRASS CAP/IRON PIPE & 1 BT.(1978)-FINDS BC/IP & 3 BT'S, SETS 1 NEW BT.
(1980)-FINDS BRASS CAP/IRON PIPE & 4 BT'S. (2008)-FINDS BC/IP & 3 BT'S, SETS 1 BT.
(2008*)-FINDS CORNER OK. (2009)-SHOWS CORNER PER M65-68.

MONUMENT FOUND/SET:

FOUND A 2-1/2" BRASS CAP ON 1-1/4" GALVANIZED IRON PIPE, PROJECTING 14 INCHES ABOVE THE GROUND.

REGISTERED PROFESSIONAL LAND SURVEYOR

[Signature]

OREGON DECEMBER 3, 2014 JONATHAN B. DREW II 89396

EXPIRES: 12/31/2015

RECORD CORNER ACCESSORIES:

NO TRACE FOUND OF A (10" PINE)1857
NO TRACE FOUND OF A (18" FIR)1857
A 38" FIR SNAG WITH PREVIOUSLY OPENED UPPER BLAZE & HEALED LOWER BLAZE
AN INDETERMINATE SIZE FIR STUMP WITH NO MARKS VISIBLE.
A 15" FIR STUMP SHELL WITH A HEALED SINGLE BLAZE.
A 20" FIR WITH A HEALED DOUBLE BLAZE.
A 17" PINE WITH A HEALED DOUBLE BLAZE.

RECORD MEASUREMENTS:

(N60°W - 6.6 FT)1857
(S80°W - 9.2 FT)1857
(N71°W-15.8')1928.(N69°45'W-16.3')2008
(S36°E-29.0')1928, (S36°45'E-29.2')2008
(S27°W-25.4 FT)1966
(S34°E-23.0')1978, (S30°30'E-22.6')2008
(N49°W-54.6 FT)2008

NEW CORNER ACCESSORIES:

NO NEW ACCESSORIES ADDED.

METHOD OF MEASUREMENT:

TRIMBLE R6 RTK BASE & ROVER GPS
NO NEW MEASUREMENTS TO BT'S.

CORNER MAINTENANCE/OTHER INFO:

CLEAR BRUSH FROM AROUND MONUMENT AND TO BT'S. TIE FLAGGING TO MONUMENT AND GUARD POSTS, PAINT BT FACES & A 6" BAND AT HEAD HEIGHT, ADD NEW NAILS TO EXISTING BT TAGS & ADD NEW TAGS WHERE NEEDED.

FILED AS CONDITION REPORT.

GEODETIC COORDINATES:

LATITUDE: N 42° 54' 06.73338"
LONGITUDE: W 122° 54' 45.99064"
ELLIPSOID HEIGHT: 1804.5 FT
DATUM: NAD_83(2011)(EPOCH:2010.0000)
SOURCE: DIRECT OCCUPATION, RTK & STATIC GPS, OPUS CORRECTED BASE.
DATE OF INVESTIGATION: 6/15/2015

DOCUMENTS ON FILE AT:

3106 PIERCE PARKWAY, STE. D
SPRINGFIELD, OREGON 97477

REPORT BY: JONATHAN B. DREW II, PLS#89396, CFedS#1664

ASSISTED BY: ANDREW HILLMAN, SURVEY TECH.

THIS DOCUMENT FILED IN CS OFFICE: YES
OTHER DOCUMENT FILED WITH CS: NONE

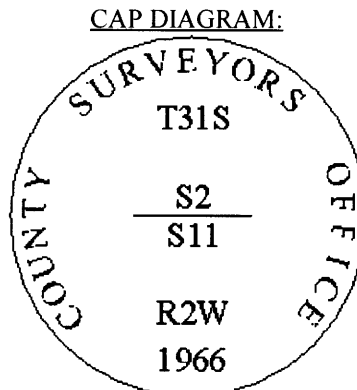

C.S. File No 65/90-49