

FS INDEX ID: B-16

CORNER INVESTIGATION REPORT

CORNER: NE 1/16 GCDB ID: 460660 DATE: 7/31/2015 HISTORY OF VISITATIONS:
TOWNSHIP: 31S STATE: OREGON 1978-G.S. BAUGHMAN, M65-69
RANGE: 2W COUNTY: DOUGLAS
SECTION: 3 FOREST: UMPQUA
MERIDIAN: W.M. DISTRICT: TILLER
NFSL PROPERTY BOUNDARY CORNER?: YES NO
LINE(S) POSTED: NORTH-1978 EAST-1978
MAINTAINED: NORTH-2015 EAST-2015
GUARD POST(S): NORTH-2.8 FT EAST-5.7 FT
CORNER HISTORY:

(1978)-ESTABLISHED NORTH EAST 1/16 CORNER, SETS BRASS CAP/IRON PIPE & 2 BT'

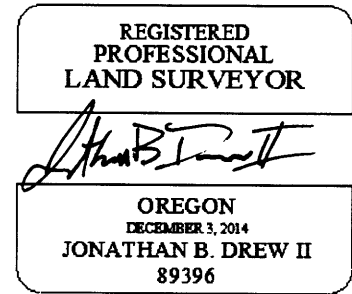

MONUMENT FOUND/SET:

FOUND A 3" BRASS CAP ON 2-1/2" GALVANIZED IRON PIPE, PROJECTING 2 INCHES ABOVE THE GROUND.

RECORD CORNER ACCESSORIES:

A 22" FIR WITH A HEALED DOUBLE BLAZE.
A 24" FIR WITH A HEALED DOUBLE BLAZE.

EXPIRES: 12/31/2015
RECORD MEASUREMENTS:
 (N18°30'E - 13.3 FT)1978
 (S44°W - 36.2 FT)1978

FILED

Date: 8-25-2015 By: JC
 This survey consists of:
Map: _____
Narrative: _____
Corner Rpt: CS 65/90-36

DOUGLAS COUNTY SURVEYOR

NEW CORNER ACCESSORIES:

NO NEW ACCESSORIES ADDED.

METHOD OF MEASUREMENT:

NO NEW MEASUREMENTS TAKEN.

CORNER MAINTENANCE/OTHER INFO:

FILED AS CONDITION REPORT.

CLEAR BRUSH FROM AROUND MONUMENT AND TO BT'S. TIE FLAGGING TO MONUMENT AND GUARD POSTS. PAINT BT FACES & A 6" BAND AT HEAD HEIGHT, ADD NEW NAILS TO EXISTING BT TAGS & ADD NEW TAGS WHERE NEEDED.

GEODETTIC COORDINATES:

LATITUDE: N 42° 54' 46.715"
LONGITUDE: W 122° 55' 39.101"
ELLIPSOID HEIGHT: 1600 FT
DATUM: WGS 84

DOCUMENTS ON FILE AT:

3106 PIERCE PARKWAY, STE. D
SPRINGFIELD, OREGON 97477

SOURCE: USGS QUAD MAP. FOR NAVIGATION TO CORNER.

DATE OF INVESTIGATION: 7/15/2015

REPORT BY: JONATHAN B. DREW II, PLS#89396, CFedS#1664

ASSISTED BY: ANDREW HILLMAN, SURVEY TECH.

THIS DOCUMENT FILED IN CS OFFICE:

YES

OTHER DOCUMENT FILED WITH CS:

NONE

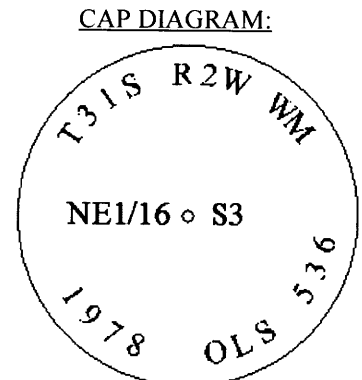

C.S. File No 65/90-36