

FS INDEX ID: J-25 & J-1

CORNER INVESTIGATION REPORT

CORNER: SECTION
TOWNSHIP: 32S
RANGE: 2W & 1W
SECTION: 12/13 & 7/18
MERIDIAN: W.M.

GCDB ID: 700500 & 100500 **DATE:** 6/4/2015
STATE: OREGON
COUNTY: DOUGLAS
FOREST: UMPQUA
DISTRICT: TILLER

NFSL PROPERTY BOUNDARY CORNER?: YES NO

LINE(S) POSTED: EAST-1979 WEST-1976
MAINTAINED: EAST-2015 WEST-2013
GUARD POST(S): EAST-4.9 FT WEST-5.1 FT

CORNER HISTORY:

(1883)-ESTABLISHED SECTION CORNER, SETS POST & 4 BT'S.
 (1902)-FINDS DECAYED POST & 4 BT'S, SETS POST & 3 BT'S.
 (1963)-FINDS 3 BT'S, SETS BRASS CAP/IRON PIPE & 3 BT'S. (1970)-FINDS OK
 (1976)-FINDS BC/IP & 4 BT'S, MARKS 3 BT'S.(1979)-FINDS BC/IP & 7 BT'S, MARKS 1 BT.
 (1985)-FINDS BC/IP & 5 BT'S, MARKS 1 BT. (2013)-FINDS BC/IP & 8 BT'S.

MONUMENT FOUND/SET:

FOUND A 2-1/2" BRASS CAP ON 1-1/4" GALVANIZED IRON PIPE, PROJECTING 12 INCHES ABOVE A MOUND OF STONE.

RECORD CORNER ACCESSORIES:

REMAINS OF AN INDT. SIZE FIR STUMP BEARS, N61°45'E-19.5 FT, WITH NO MARKS.
 NO TRACE FOUND OF A (3" FIR)1883
 NO TRACE FOUND OF A (4" FIR)1883
 NO TRACE FOUND OF A (14" FIR)1883
 NO TRACE FOUND OF A (30" FIR)1902
 NO TRACE FOUND OF A (12" FIR)1902
 REMAINS OF AN INDT. SIZE FIR STUMP BEARS, N27°45'W-19.6 FT, WITH AX WORK.
 A ROOT HOLE WITH ROTTED LOG ALONGSIDE BEARS, N38°45'W-48.0 FT.
 A ROOT HOLE BEARS, N21°30'E - 50.1 FT, WITH NO TRACE OF LOG.
 NO TRACE FOUND OF A (5" W.FIR)1963
 A 21" FIR BEARS, N85°W-23.1 FT, WITH A HEALED DOUBLE BLAZE.
 A 25" FIR BEARS, S32°15'E-22.1 FT, WITH SCRIBE ON PART. HEALED DOUBLE BLAZE.
 REMAINS OF A ROTTEN LOG WITH TAGS & NO MARKS, NO ROOT HOLE FOUND.
 A 20" FIR BEARS, S69°30'W - 40.4 FT, WITH A HEALED DOUBLE BLAZE.
 A 14" FIR WINDFALL BEARS, N7°15'E-16.0 FT, LOG LIES WEST.

NEW CORNER ACCESSORIES:

A 16" FIR BEARS, N73°30'E - 5.7 FT, MARKED "T32SR1WS7""BT" ON A DOUBLE BLAZE.

CORNER MAINTENANCE/OTHER INFO:

CLEAR BRUSH FROM AROUND MONUMENT AND TO BT'S. TIE FLAGGING TO MONUMENT AND GUARD POSTS, PAINT BT FACES & A 6" BAND AT HEAD HEIGHT, ADD NEW NAILS TO EXISTING BT TAGS & ADD NEW TAGS WHERE NEEDED.

NEW BT INCLUDES 3/4" BRASS WASHER MARKED "ORPLS #89396" BETWEEN B & T.
GEODETIC COORDINATES: **DOCUMENTS ON FILE AT:**

LATTITUDE: N 42° 47' 47.126" 3106 PIERCE PARKWAY, STE. D
 LONGITUDUE: W 122° 52' 24.475" SPRINGFIELD, OREGON 97477
 ELIPSOID HEIGHT: 3215 FT
 DATUM: WGS 84

SOURCE: CELL PHONE GPS, FOR NAVIGATION TO CORNER

DATE OF INVESTIGATION: 6/3/2015

REPORT BY: JONATHAN B. DREW II, PLS#89396

ASSISTED BY: ANDREW HILL,MAN, SURVEY TECH.

HISTORY OF VISITATIONS:

1883-R.S. MOORE, GLO SURVEY
 1902-C.L. CAMPBELL-GLO RESURVEY
 1963-J. BYRON ET. AL., CS 53/15
 1970-V. TRACY, CS 54/117
 1976-G.S. BAUGHMAN, M56-68
 1979-G.S. BAUGHMAN, CS 58/176-41
 1985-L.R. MOFFIT, CS 63/8
 2013-J.C. RANSOM ET. AL., CS 65/85-31

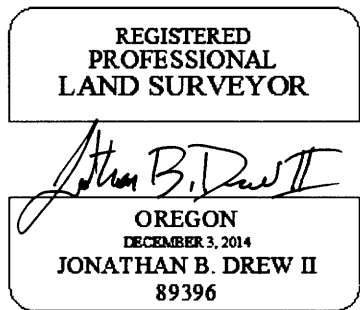

EXPIRES: 12/31/2015
RECORD MEASUREMENTS:

(N58°E-19.1')1883, (N61°45'E-19.5')2013
 (S74°E - 15.2 FT)1883
 (S65°W - 4.6 FT)1883
 (N58°W - 4.6 FT)1883
 (S50°E - 29.0 FT)1902, 1963, 1976 & 1979
 (S31°45'W - 40.3 FT)1902
 (N29°W-20.5')1902,(N27°45'W-19.6')2013
 (N38W-48.7')1963, (N38°45'W-48.0')2013
 (N22°E-49.6')1963, (N21°30'E-50.1')2013
 (S86°E-68.3')1963 & 1976
 (N85°W-23.3')1976, (N85°W-23.1')2013
 (S34°E-21.6')1976, (S32°15'E-22.1')2013
 (N15°W - 62.3 FT)1976 & 1979
 (S72°W-40.3')1979, (S69°30'W-40.4')2013
 (N1°E-15.9')1985, (N7°15'E-16.0')2013

METHOD OF MEASUREMENT:

LEICA TCRA 1103+, HOLD BEARING S89°51'50"W ON STEEL POST FOUND 66.0 FT WEST OF CORNER. PER M56-68

CAP DIAGRAM:

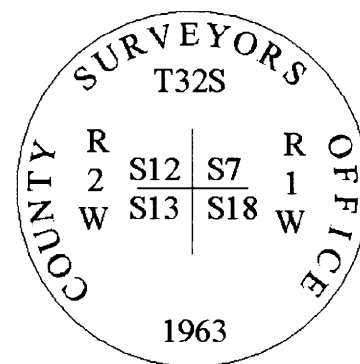

THIS DOCUMENT FILED IN CS OFFICE: YES
OTHER DOCUMENT FILED WITH CS: NONE

C.S. File No 65/90-28