

FS INDEX ID: E-25 & E-1

# CORNER INVESTIGATION REPORT

**CORNER:** SECTION GCDB ID: 700600 & 100600 **DATE:** 5/25/2015  
**TOWNSHIP:** 32S **STATE:** OREGON  
**RANGE:** R2W & R1W **COUNTY:** DOUGLAS  
**SECTION:** 1&12 | 6&7 **FOREST:** UMPQUA  
**MERIDIAN:** W.M. **DISTRICT:** TILLER  
**NFSL PROPERTY BOUNDARY CORNER?:**  YES  NO

**HISTORY OF VISITATIONS:**  
 1883-R.S. MOORE, GLO SURVEY  
 1963-J.W. BYRON ET. AL, CS 53/15  
 1970-B.A. SHANER, RM 2-21  
 1980-L. HERZSTEIN, USFS CNR CARD

**LINE(S) POSTED:** NORTH-1970 EAST-1970  
**MAINTAINED:** NORTH-2015 EAST-2015  
**GUARD POST(S):** NORTH-4.2 FT EAST-4.3 FT

**CORNER HISTORY:**

- (1883)-ESTABLISHED SECTION CORNER, SET STONE & 4 BT'S.
- (1963)-FINDS STONE & 2 BT'S, SETS BRASS CAP/IRON PIPE & 3 BT'S.
- (1970)-FINDS BRASS CAP/IRON PIPE & 5 BT'S. BEARINGS & DISTANCES @ RECORD.
- (1980)-REPORTS CORNER OK & PLACE SIGNS ON 5 BT'S.

**MONUMENT FOUND/SET:**

FOUND A 2-1/2" DCSO BRASS CAP ON 1-1/2" GALVANIZED IRON PIPE, PROJECTING 11 INCHES ABOVE A MOUND OF STONE.

**RECORD CORNER ACCESSORIES:**

- NO TRACE FOUND OF A (4" VINE MAPLE)1883
- NO TRACE FOUND OF A (15" CEDAR)1883
- AN INDETERMINATE SIZE FIR SNAG WITH NO MARKS VISIBLE.
- A 32" FIR WITH A HEALED SINGLE BLAZE.
- A 48" DOUBLE CEDAR WITH A HEALED SINGLE BLAZE.
- A 24" CEDAR WITH A HEALED DOUBLE BLAZE.
- A 19" FIR WITH A HEALED DOUBLE BLAZE.

**NEW CORNER ACCESSORIES:**

NO NEW ACCESSORIES NEEDED.

**CORNER MAINTENANCE/OTHER INFO:**

CLEAR BRUSH FROM AROUND MONUMENT AND TO BT'S. TIE FLAGGING TO MONUMENT AND GUARD POSTS, PAINT BT FACES & A 6" BAND AT HEAD HEIGHT, ADD NEW NAILS TO EXISTING BT TAGS & ADD NEW TAGS WHERE NEEDED.

**GEODETIC COORDINATES:**

LATTITUDE: N 42° 48' 38.875"  
 LONGITUDE: W 122° 52' 23.651"  
 ELIPSOID HEIGHT: 2690 FT  
 DATUM: WGS 84

**DOCUMENTS ON FILE AT:**

3106 PIERCE PARKWAY, STE. D  
SPRINGFIELD, OREGON 97477

SOURCE: USGS QUAD MAP, FOR NAVIGATION TO CORNER.

**DATE OF INVESTIGATION:** 5/14/2015

**REPORT BY:** JONATHAN B. DREW II, PLS 89396

**ASSISTED BY:** LANCE GOUCHER, SURVEY TECH.  
 ANDREW HILLMAN, SURVEY TECH.

**THIS DOCUMENT FILED IN CS OFFICE:** YES  
**OTHER DOCUMENT FILED WITH CS:** NONE

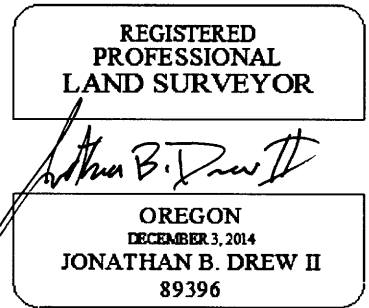

**EXPIRES:** 12/31/2015  
**RECORD MEASUREMENTS:**

- (N27°E-16.5')1883
- (S60°W-6.6')1883
- (S35°E-4.6')1883
- (N36°W-7.3')1883
- (N17°E-44.0')1963
- (S57°W-81.0')1963
- (S86°E-64.6')1963

**METHOD OF MEASUREMENT:**

NO NEW MEASUREMENTS TAKEN.

FILED AS CONDITION REPORT

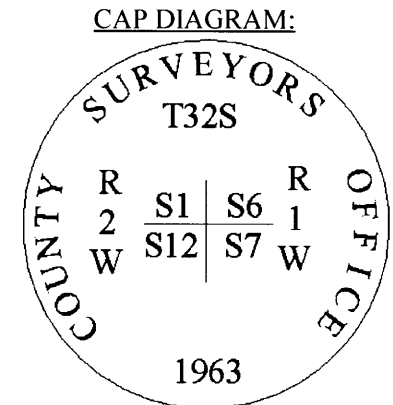

C.S. File No 65/90-27