

FS INDEX ID: J-7

# CORNER INVESTIGATION REPORT

**CORNER:** 1/4  
**TOWNSHIP:** 32S  
**RANGE:** 1W  
**SECTION:** 8 & 17  
**MERIDIAN:** W.M.

**GCDB ID:** 240500  
**STATE:** OREGON  
**COUNTY:** DOUGLAS  
**FOREST:** UMPQUA  
**DISTRICT:** TILLER

**DATE:** 6/3/2015

**HISTORY OF VISITATIONS:**

1883-R.S. MOORE, GLO SURVEY  
 1968-J.M. POWELL ET. AL, CS 54/71  
 1979-G.S. BAUGHMAN, CS 58/176  
 1985-L.R. MOFFIT, CS 62/30

**NFSL PROPERTY BOUNDARY CORNER?:**  YES  NO

**LINE(S) POSTED:** EAST-1979 WEST-1979  
**MAINTAINED:** EAST-2015 WEST-2015  
**GUARD POST(S):** EAST-NONE WEST-NONE

**CORNER HISTORY:**

- (1883)-ESTABLISHED 1/4 CORNER, SETS POST & 2 BT'S.
- (1968)-FINDS 2 BT'S, SETS BRASS CAP/IRON PIPE & 2 BT'S.
- (1979)-FINDS 2 BT'S, SETS BRASS CAP/IRON PIPE, 1968 MONUMENT GONE OR UNDER ROAD FILL.
- (1985)-FINDS BRASS CAP/IRON PIPE & 2BT'S, SETS 1 NEW BT.

**MONUMENT FOUND/SET:**

FOUND A 3" BRASS CAP ON 2-1/2" GALVANIZED IRON PIPE, PROJECTING 3 INCHES ABOVE A MOUND OF STONE, SURROUNDED BY A 8 FOOT DIAMETER COLLAR OF LARGE ROCKS.

**RECORD CORNER ACCESSORIES:**

- NO TRACE FOUND OF A (12" MATHERONE)1883
- NO TRACE FOUND OF A (25" FIR)1883
- A 8" CEDAR STUB BEARS, N46°57'W - 91.8 FT, WITH SCRIBE VISIBLE ON A PARTIALLY HEALED SINGLE BLAZE.
- A 21" MADRONE SNAG BEARS, S78°34'W - 103.8 FT, WITH SCRIBE VISIBLE ON A PARTIALLY HEALED DOUBLE BLAZE.
- A 21" FIR BEARS, N47°20'W - 94.3 FT, WITH A HEALED DOUBLE BLAZE.

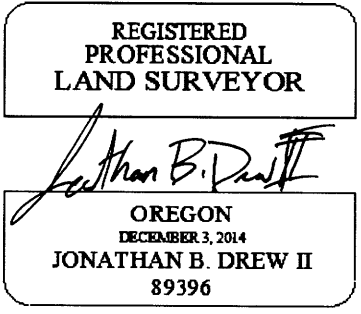

EXPIRES: 12/31/2015

**RECORD MEASUREMENTS:**

(N60°E-5.9')1882, (N60°E-5.4')1968  
 (S50°E-24.4')1883, (S50°W-26.6')1968  
 (N46°W-92.0 FT)1968, 1979 & 1985  
 (S78°W-103.7 FT)1968, 1979 & 1985  
 (N46°45'W - 94.3 FT)1985

**NEW CORNER ACCESSORIES:**

- A 14" CEDAR BEARS, S65°41'E - 86.6 FT, MARKED "1/4S17"BT" ON A DOUBLE BLAZE.
- A 8" FIR BEARS, N80°54'E - 164.1 FT, MARKED "X"BT" ON A DOUBLE BLAZE.
- A 19" FIR BEARS, S7°W - 25.5 FT, MARKED "1/4S17"BT" ON A DOUBLE BLAZE.

**METHOD OF MEASUREMENT:**

LEICA TCRA1103+, TRIMBLE R6 RTK BEARING BASIS: MEAN GEODETIC BASED ON RTK/STATIC GPS ON CORNER AND SPIKE SET N10°34'52"W 171.32 FEET, OPUS CORRECTED BASE. DISTANCE TO NAIL SET SIDE CENTER BEARINGS TO CENTER.

**CORNER MAINTENANCE/OTHER INFO:**

CLEAR BRUSH FROM AROUND MONUMENT AND TO BT'S. TIE FLAGGING TO MONUMENT AND GUARD POSTS, PAINT BT FACES & A 6" BAND AT HEAD HEIGHT, ADD NEW NAILS TO EXISTING BT TAGS & ADD NEW TAGS WHERE NEEDED.

**CAP DIAGRAM:**

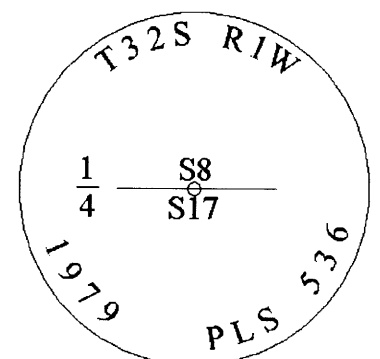

**GEODETIC COORDINATES:**

LATTITUDE: N 42°47'42.69708"  
 LONGITIDUE: W 122°50'37.13067"  
 ELIPSOID HEIGHT: 3251.7 FT  
 DATUM: NAD\_83(2011)(EPOCH:2010.0000)

**DOCUMENTS ON FILE AT:**

3106 PIERCE PARKWAY, STE. D  
 SPRINGFIELD, OREGON 97477

SOURCE: RTK & STATIC GPS FROM OPUS CORRECTED BASE.

**DATE OF INVESTIGATION:** 6/2/2015

**REPORT BY:** JONATHAN B. DREW II, PLS 89396

**ASSISTED BY:** ANDREW HILLMAN, SURVEY TECH.

**THIS DOCUMENT FILED IN CS OFFICE:** YES  
**OTHER DOCUMENT FILED WITH CS:** NONE

C.S. File No 65/90-24