

FS INDEX ID: E-3

CORNER INVESTIGATION REPORT

CORNER: 1/4
TOWNSHIP: 32S
RANGE: R1W
SECTION: 6 & 7
MERIDIAN: W.M.
GCDB ID: 140600
STATE: OREGON
COUNTY: DOUGLAS
FOREST: UMPQUA
DISTRICT: TILLER
NFSL PROPERTY BOUNDARY CORNER?: [x] YES [ ] NO

LINE(S) POSTED: EAST-1970 WEST-1970
MAINTAINED: EAST-2015 WEST-2015
GUARD POST(S): EAST-5.1 FT WEST-1.6 FT

CORNER HISTORY:

(1883)-ESTABLISHED 1/4 CORNER, SET POST & 2 BT'S.
(1963)-FINDS 1 BT'S, SETS BRASS CAP/IRON PIPE & 2 BT'S.
(1968)-FINDS BRASS CAP/IRON PIPE & 2 BT'S. SETS 1 NEW BT.
(1970)-FINDS BRASS CAP/IRON PIPE & 4 BT'S. (1980)-CNR OK, SIGNS ON 4 BT'S.
(2004)-FINDS BRASS CAP/IRON PIPE & 2 BT'S, SETS 4 NEW BT'S.

MONUMENT FOUND/SET:

FOUND A 2-1/2" DCSO BRASS CAP ON 1-1/4" GALVANIZED IRON PIPE, PROJECTING 15 INCHES ABOVE A MOUND OF STONE.

RECORD CORNER ACCESSORIES:

NO TRACE FOUND OF A (6" MATHERONE)1883
NO TRACE FOUND OF A (12" FIR)1883
AN INDETERMINATE SIZE ROTTEN FIR STUMP WITH NO MARKS VISIBLE.
A 16" ROTTEN FIR HIGH STUMP WITH NO MARKS VISIBLE.
A FIR ROOT HOLE AND SHELL SHOWS HEALED SINGLE BLAZE, 12" LOG ALONGSIDE.
A 15" FIR WITH A HEALED SINGLE BLAZE.
A 11" FIR WITH A HEALED SINGLE BLAZE.
A 13" PINE WITH SCRIBE VISIBLE ON A PARTIALLY HEALED SINGLE BLAZE.
A 13" PINE WITH SCRIBE VISBLE ON A PARTIALLY HEALED SINGLE BLAZE.

NEW CORNER ACCESSORIES:

NO NEW ACCESSORIES NEEDED.

CORNER MAINTENANCE/OTHER INFO:

CLEAR BRUSH FROM AROUND MONUMENT AND TO BT'S. TIE FLAGGING TO MONUMENT AND GUARD POSTS, PAINT BT FACES & A 6" BAND AT HEAD HEIGHT, ADD NEW NAILS TO EXISTING BT TAGS & ADD NEW TAGS WHERE NEEDED.

GEODETTIC COORDINATES:

LATTITUDE: N 42° 48' 37.55299"
LONGITUDUE: W 122° 51' 50.20728"
ELIPSOID HEIGHT: 2360.8 FT

DATUM: PER OPUS: NAD\_83(2011)(EPOCH:2010.0000)
SOURCE: RTK&STATIC GPS OBSERVATIONS FROM OPUS CORRECTED BASE.

DATE OF INVESTIGATION: 5/12/2015

REPORT BY: JONATHAN B. DREW II, PLS 89396

ASSISTED BY: LANCE GOUCHER, SURVEY TECH.

DATE: 5/25/2015

HISTORY OF VISITATIONS:

1883-R.S. MOORE, GLO SURVEY
1963-J.W. BYRON ET. AL, CS 53/15
1968-J.M. POWELL ET. AL, CS 54/71
1970-B.A. SHANER, RM 2-21
1980-L. HERZSTEIN, USFS CNR CARD
2004-R. WYTCHERLY, M144-50

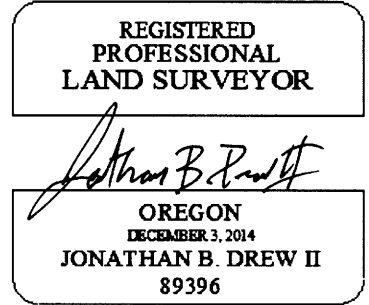

EXPIRES: 12/31/2015

RECORD MEASUREMENTS:

(N50°E-6.6')1883
(S50°W-6.6')1883
(N60°W-17.2')1963
(S72°W-12.0')1963
(S53°E-133.5')1968
(N1°28'W-48.41')2004
(N52°E-14.24')2004
(S67°W-24.6')2004
(S20°E-39.24')2004

METHOD OF MEASUREMENT:

TRIMBLE R6 RTK SYSTEM, STATIC AT RTK OBSERVATIONS MADE ON CORNER MONUMENT, NO NEW MEASUREMENTS OF BT'S MADE.

FILED AS CONDITION REPORT.

CAP DIAGRAM:

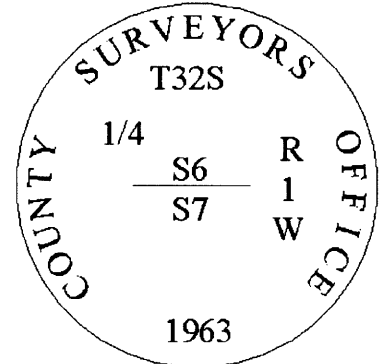

THIS DOCUMENT FILED IN CS OFFICE: YES
OTHER DOCUMENT FILED WITH CS: NONE

C.S. File No 65/90-19