

FS INDEX ID: C-25 & C-1

CORNER INVESTIGATION REPORT

CORNER: 1/4 GCDB ID: 700640 & 100640 DATE: 6/1/2015
TOWNSHIP: 31 S STATE: OREGON
RANGE: 2W & 1W COUNTY: DOUGLAS
SECTION: 6 & 1 FOREST: UMPQUA
MERIDIAN: W.M. DISTRICT: TILLER
NFSL PROPERTY BOUNDARY CORNER?: [x] YES [] NO
LINE(S) POSTED: SOUTH-1967 WEST-1967
MAINTAINED: SOUTH-2015 WEST-2015
GUARD POST(S):

HISTORY OF VISITATIONS:
1857-DENNIS HATHORN, GLO SURVEY
1966-JOHN POWELL ET AL., CS 54/28
1967-G.S. BAUGHMAN, M34-23
1979-KURT WEAVER, M81-28, CS 58/216
1980-L. HERZSTEIN, USFS CORNER CARD
2003-L. HERZSTEIN, BLM RESURVEY

CORNER HISTORY:

(1857)-ESTABLISHES 1/4 CORNER, SETS POST & 2 BT'S.
(1966)-FINDS 2 BT'S, SETS BRASS CAP/IRON PIPE & 2 BT'S.
(1967, 1979 & 1980)-FINDS BRASS CAP/IRON PIPE & 4 BT'S.
(2003)-FINDS BRASS CAP/IRON PIPE & 3 BT'S.

MONUMENT FOUND/SET:

FOUND A 2-1/2" DCSO BRASS CAP ON 1-1/4" GALVANIZED IRON PIPE, PROJECTING 12 INCHES ABOVE A MOUND OF STONE.

RECORD CORNER ACCESSORIES:

A 26" OAK WITH A HOLLOWED OUT DOUBLE BLAZE.
NO TRACE FOUND OF A (20" OAK)1857
A 24" FIR WITH A HEALED SINGLE BLAZE.
A 18" FIR WITH A HEALED SINGLE BLAZE.

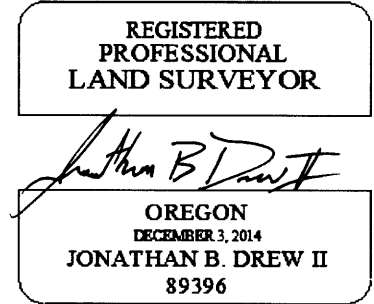

EXPIRES: 12/31/2015
RECORD MEASUREMENTS:

(N60°W-15.2')1857, (N60°W-16.3')2003
(S80°E - 9.9 FT)1857 & 1966
(S55°30'W-10.8')1966,(S56°15'W-9.9')2003
(N55°30'E-19.6')1966,(N58°30'E-19.6')2003

NEW CORNER ACCESSORIES:

NO NEW ACCESSORIES NEEDED.

METHOD OF MEASUREMENT:

NO NEW MEASUREMENTS TAKEN.
GUARD POST(S) PRESENT, NOT MEASURED.

FILED AS CONDITION REPORT

CORNER MAINTENANCE/OTHER INFO:

CLEAR BRUSH FROM AROUND MONUMENT AND TO BT'S. TIE FLAGGING TO MONUMENT AND GUARD POSTS, PAINT BT FACES & A 6" BAND AT HEAD HEIGHT, ADD NEW NAILS TO EXISTING BT TAGS & ADD NEW TAGS WHERE NEEDED.

GEODETIC COORDINATES:

LATTITUDE: N 42° 54' 33.307"
LONGITUDUE: W 122° 52' 58.155"
ELIPSOID HEIGHT: 2840 FT
DATUM: WGS84

DOCUMENTS ON FILE AT:

3106 PIERCE PARKWAY, STE. D
SPRINGFIELD, OREGON 97477

SOURCE: USGS QUAD MAP, FOR NAVIGATION TO CORNER.

DATE OF INVESTIGATION: 5/7/2015

REPORT BY: JONATHAN B. DREW II, PLS 89396

ASSISTED BY: LANCE GOUCHER, SURVEY TECH.
ANDREW HILLMAN, SURVEY TECH.

THIS DOCUMENT FILED IN CS OFFICE: YES
OTHER DOCUMENT FILED WITH CS: NONE

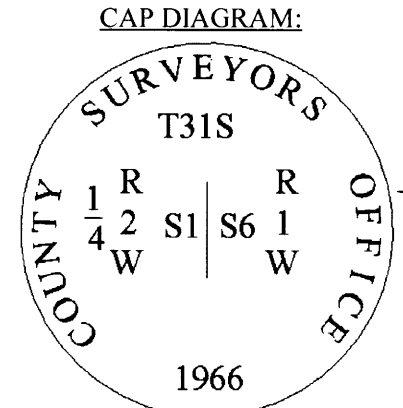

C.S. File No 65/90-18