

FS INDEX ID: H-9

CORNER INVESTIGATION REPORT

CORNER: S 1/16 GCDB ID: 300520
TOWNSHIP: 31 S STATE: OREGON
RANGE: 1 W COUNTY: DOUGLAS
SECTION: 8 & 9 FOREST: UMPQUA
MERIDIAN: W.M. DISTRICT: TILLER
NFSL PROPERTY BOUNDARY CORNER?: YES NO

DATE: 6/1/2015

HISTORY OF VISITATIONS:

1977-WILLIAM J. RUPPERT, M65-50
2001-LES FANNING, CS 65/36-6

LINE(S) POSTED: NORTH-1977 WEST-1977
MAINTAINED: NORTH-2015* WEST-2015
GUARD POST(S): NORTH-3.2 FT WEST-4.1 FT

CORNER HISTORY:

(1977)-ESTABLISHES S 1/16 SECTIONS 8 & 9, SETS BRASS CAP/IRON PIPE & 2 BT'S.
(2001)-FINDS BRASS CAP/IRON PIPE & 2 BT'S, MARKS 1 NEW BT.

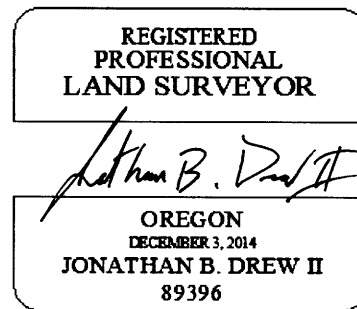

MONUMENT FOUND/SET:

FOUND A 2-1/2" BRASS CAP ON 2-1/2" GALVANIZED IRON PIPE, 1 INCH BELOW TOP OF A MOUND OF STONE.

EXPIRES: 12/31/2015

RECORD MEASUREMENTS:

(S43°20'E - 16.8 FT)1977 & 2001
(N23°03'W - 45.7 FT)1977 & 2001
(N17°W - 36.7 FT)2001

RECORD CORNER ACCESSORIES:

A 20" FIR WITH A HEALED DOUBLE BLAZE.
A 15" FIR STUB WITH SCRIBE/WASHER VISIBLE ON A PART. HEALED DOUBLE BLAZE
A 15" FIR WITH A HEALED DOUBLE BLAZE.

NEW CORNER ACCESSORIES:

NO NEW ACCESSORIES NEEDED.

METHOD OF MEASUREMENT:

NO NEW MEASUREMENTS TAKEN.

FILED AS CONDITION REPORT.

CORNER MAINTENANCE/OTHER INFO:

CLEAR BRUSH FROM AROUND MONUMENT AND TO BT'S. TIE FLAGGING TO MONUMENT AND GUARD POSTS, PAINT BT FACES & A 6" BAND AT HEAD HEIGHT, ADD NEW NAILS TO EXISTING BT TAGS & ADD NEW TAGS WHERE NEEDED.

CAP DIAGRAM:

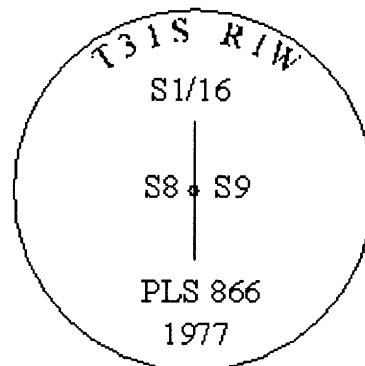

*LINE TO THE NORTH OF CORNER 1/4 MILE EXPECTED TO BE MAINTAINED FY2015

GEODETIC COORDINATES:

DOCUMENTS ON FILE AT:

LATTITUDE: N 42° 53' 27.520"

3106 PIERCE PARKWAY, STE. D

LONGITUDUE: W 122° 50' 36.517"

SPRINGFIELD, OREGON 97477

ELIPSOID HEIGHT: 3125 FT

DATUM: WGS84

SOURCE: USGS QUAD MAP, FOR NAVIGATION TO CORNER

DATE OF INVESTIGATION: 4/29/2015

REPORT BY: JONATHAN B. DREW II, PLS 89396

ASSISTED BY: LANCE GOUCHER, SURVEY TECH.

THIS DOCUMENT FILED IN CS OFFICE: YES
OTHER DOCUMENT FILED WITH CS: NONE

C.S. File No 65/90-9