

FILED

Date: 10-5-2015 By: X

This survey consists of:

Map: _____

Narrative: _____

Corner Rpt: CS 65/89-42

DOUGLAS COUNTY
SURVEYOR

CORNER REPORT FORM

Section 6 Township 32S Range 4W
Douglas County Date 9/2015
PLSS Number 100640

CORNER DESIGNATION

1/4 COR 51/56

<input checked="" type="checkbox"/>
<input type="checkbox"/>
<input type="checkbox"/>
<input type="checkbox"/>
<input type="checkbox"/>
<input type="checkbox"/>

Condition Report only
Not Found
Renewed
Unrecorded
Surveyed In
Referenced out

Previous Renewals/Surveys, etc:

Templid 1958 CS 42/389

Templid 1994 PP 1995-0115

DCSO 1984 CS 62/21

BLM Resurvey 2013 PG.23131-2

Monument(s) & Accessories Found: (Condition and Source)

2 1/2" DCSO BRASS CAP
 24" FIR S85°E 25.6' GOOD SCAR
 13" MAPLE S38E 13.4' VIS SCRIBE
 24" FIR STUMP S16W 43.9 FT MOSTLY ROTTEN
 15" MAPLE S57W 35.3 FT VIS SCRIBE
 27" CEDAR N22W 57.5 FT GOOD SCAR

Monument Detail

Sketch

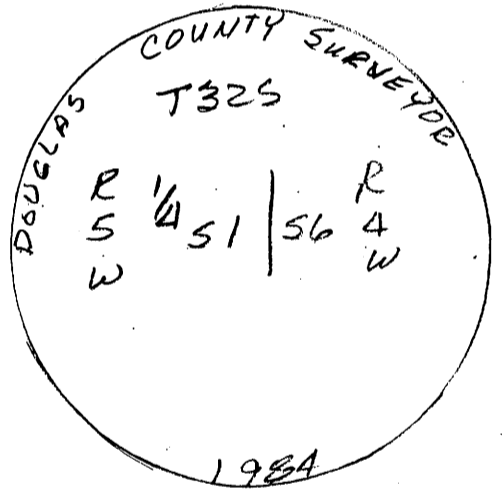

Monument Set (Procedures and Description)

New Accessories

Location & Comments

LAT & LONG
 N 42° 49.124'
 W 123° 13.690'
 COR IS ON EAST
 FACING SLOPE
 300'± WEST OF
 ROAD

Compass Declination 15 1/2° E

Firm/Agency: I.e. Engineering, Inc.

Address: 809 SE Pine St., Roseburg, OR 97470

Party Chief: N. KRONDAHL

Notes:

Witness: R. OLSON

Surveyor's Seal

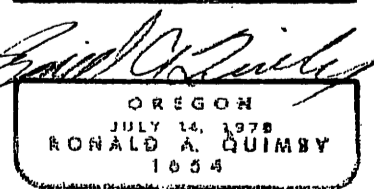
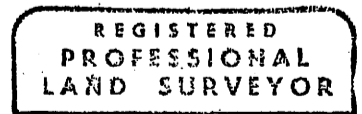

EXP 12-31-16

C.S. File 65/89-42