

FILED

Date: 9-30-2015 By: sc

This survey consists of:

Map: _____

Narrative: _____

Corner Rpt: CS 65/89-36

DOUGLAS COUNTY
SURVEYOR

CORNER REPORT FORM

Section 14 Township 31S Range 3W

Douglas County

Date 9/2015

PLSS Number 500500

CORNER DESIGNATION

SEC COR 10/11
15/14

- Condition Report only
- Not Found
- Renewed
- Unrecorded
- Surveyed In
- Referenced out

Previous Renewals/Surveys, etc:

MARKHAM 1959 CS 42/392 BLM RESURVEY 1964

DCSO 1964 CS 52/63

Monument(s) & Accessories Found: (Condition and Source)

- DCSO BRASS CAP.
- MADRONE STOB N49¹/₂E 32 FT BADLY BURNT
- 10" LIVE OAK S37⁰E 28 FT GOOD SCAR
- 12" PINE S5⁰E 22 FT GOOD SCAR
- 10" CHINQUAPIN S86W 10 FT GOOD SCAR
- 7" DOWN FIR (N48W 60 FT REC) BADLY BURNT

Monument Detail

Sketch

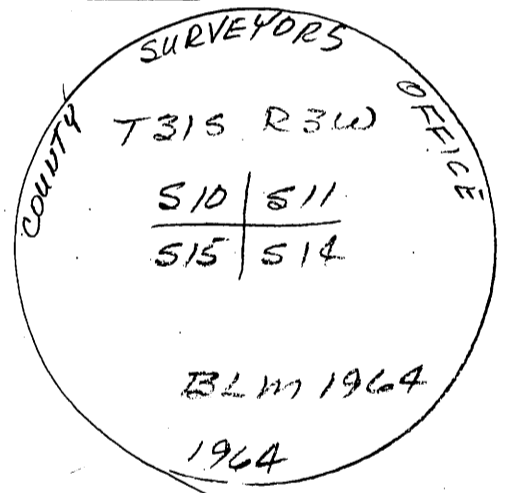

Monument Set (Procedures and Description)

New Accessories

- 5/8" I. ROD S47W 15 FT
- 5/8" I. ROD S30E 15 FT
- 5/8" I. ROD N44E 15 FT
- 5/8" I. ROD N48W 10 FT

All Rods have yellow plastic caps stamped IEE Engineering

Location & Comments

AREA BADLY
BURNT 8/2015

Surveyor's Seal

Compass Declination 15¹/₂ E
 Firm/Agency: I.e. Engineering, Inc.
 Address: 809 SE Pine St, Roseburg, OR 97470

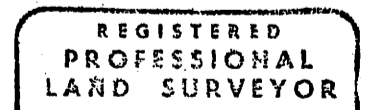

Party Chief: N. Fromdahl
 Notes:
 Witness: R. Olson

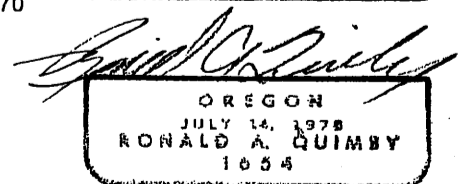

EXP 12-31-16

C.S. File 65/89-36