

FILED

Date: 9-30-2015 By: X

This survey consists of:

Map: _____

Narrative: _____

Corner Rpt: CS 65/89-35

DOUGLAS COUNTY
SURVEYOR

CORNER REPORT FORM

Section 12 Township 3/S Range 3W

Douglas County

Date 8/2015

PLSS Number 660520

CORNER DESIGNATION

SE 1/4 S12

- Condition Report only
- Not Found
- Renewed
- Unrecorded
- Surveyed In
- Referenced out

Previous Renewals/Surveys, etc:

Ruppert M 79-20 1980

Monument(s) & Accessories Found: (Condition and Source)

2 1/2" Alum CAP

22" D. FIR SW 37.5 FT GOOD SCNR (RC S 5°50'W)

26" D. FIR NBLW 14.3 FT GOOD SCNR

Monument Detail

Sketch



Monument Set (Procedures and Description)

New Accessories

Surveyor's Seal

Location & Comments

AREA BADLY BURNT

8/2015

HAND HELD LAT &

LONG

N 42° 53' 25"

W 122° 59' 54"

Compass Declination 15 1/2° E

Firm/Agency: i.e. Engineering, Inc.

Address: 809 SE Pine St, Roseburg, OR 97470

Party Chief: N. Fromm Dahl

Notes:

Witness: R. DIBSON

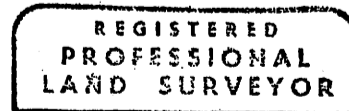

Ronald A. Quimby

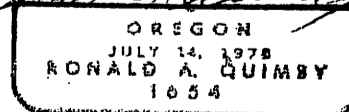

EXP 12-31-16

C.S. File 65/89-35