

FILED

Date: 9-30-2015 By: JC

This survey consists of:

Map: \_\_\_\_\_

Narrative: \_\_\_\_\_

Corner Rpt: CS 65/89-34

DOUGLAS COUNTY SURVEYOR

CORNER REPORT FORM

Section 14 Township 31S Range 3W

Douglas County

Date 8/2015

PLSS Number 600500

CORNER DESIGNATION

SEC COR. 511/512  
514/513



Condition Report only  
Not Found  
Renewed  
Unrecorded  
Surveyed In  
Referenced out

Previous Renewals/Surveys, etc:

Markham 1959 CS 42/392

DCSD 1965 CS 52/63

Monument(s) & Accessories Found: (Condition and Source)

DCSO BRASS CAP

14" LAUREL NB9E 17<sup>3</sup> FT GOOD SCENE

36" FIR SNA9 NB6W 59<sup>3</sup> FT " "

Both Trees burnt.

Monument Detail

Sketch

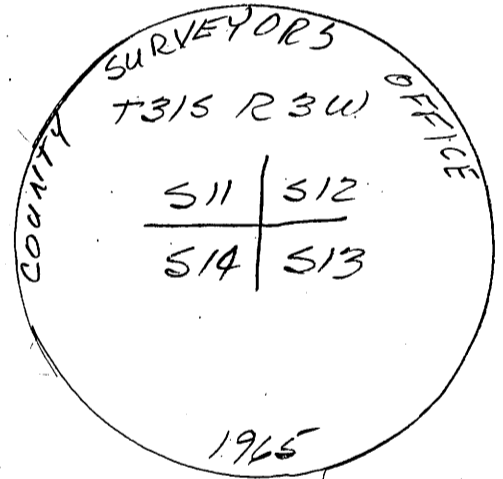

Monument Set (Procedures and Description)

New Accessories

5/8" I. ROD N52°W 30° FT

5/16" I. ROD S36W 15° FT

5/8" I. ROD S35°E 25° FT

All I. Rod HAVE Alum. CAP  
STAMPED 1E ENGINEERING  
with Alum Post

Surveyor's Seal

Location & Comments

CORNER IS APPROX  
300' EAST OF ROAD  
NEAR RIDGE TOP  
AREA BADLY BURNED  
8/2015

Compass Declination 15 1/2° E

Firm/Agency: I.e. Engineering, Inc.

Address: 809 SE Pine St., Roseburg, OR 97470

Party Chief: N. From Dahl

Notes:

Witness: R. OLSON

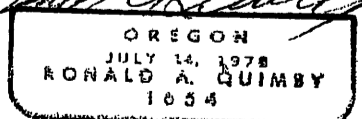
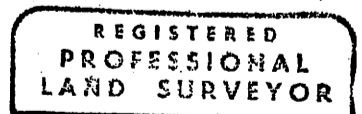

EXP 12-31-16

C.S. File 65/89-31