

FILED

Date: 9-30-2015 By: J

This survey consists of:

Map: _____

Narrative: _____

Corner Rpt: CS 65/89-29

DOUGLAS COUNTY
SURVEYOR

CORNER REPORT FORM

Section 2 Township 3/5 Range 3W

Douglas County

Date 8/2015

PLSS Number

600640

CORNER DESIGNATION

1/4 S2/51 1959 C 6 42/392



Condition Report only
Not Found
Renewed
Unrecorded
Surveyed In
Referenced out

Previous Renewals/Surveys, etc:

MARKHAM 1959

Williams Pipeline M 166-40A-1

DCSO 1965 CS 52/63

Monument(s) & Accessories Found: (Condition and Source)

DCSO 2 1/2" BRASS CAP

13" MADRONE N21°E 40 1/2 FT GOOD SCAR

14" MADRONE S81°W 8° FT " "

8" FIR (REC 9.5") N61°W 10 1/2 FT " "

23" MADRONE N13°W 42 1/2 FT " "

8" FIR S28°E (REC S32°E) 13° FT TO NAIL SIDE-CENTER

Monument Detail

Sketch

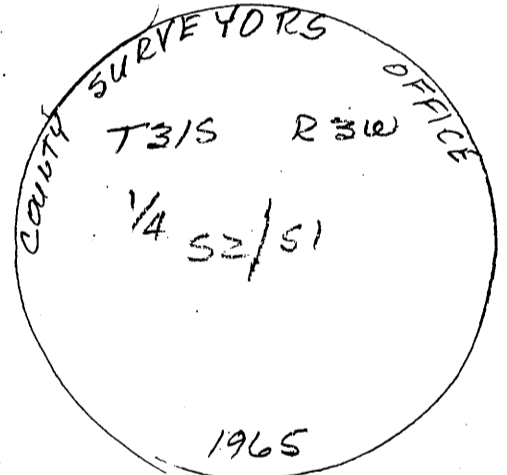

Monument Set (Procedures and Description)

New Accessories

Location & Comments

HAND HELD LATE
LONG

N 42° 54.496

W 123° 00.796

AREA BADLY

BURN + 8/2015

Compass Declination 15 1/2° E

Firm/Agency: I.e. Engineering, Inc.

Address:

809 SE Pine St., Roseburg, OR 97470

Party Chief: N. From Dahl

Notes:

Witness: R. OLSON

Surveyor's Seal

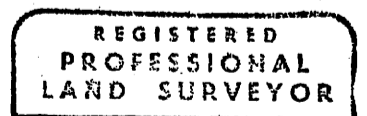

Ronald A. Quimby

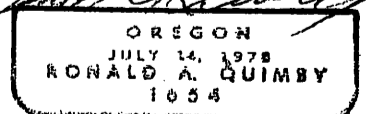

EXP 12-31-16

C.S. File 65/89-29