

FILED

Date: 5/11/2015 By: JC

This survey consists of:

Map: _____

Narrative: _____

Corner Rpt: CS 65/89-3

DOUGLAS COUNTY
SURVEYOR

CORNER REPORT FORM

Section 34 Township 24S Range 2W
Douglas County Date 5-2015
PLSS Number
400140

CORNER DESIGNATION

1/4 S 33/534

- Condition Report only
- Not Found
- Renewed
- Unrecorded
- Surveyed In
- Referenced out

Previous Renewals/Surveys, etc:

BLM Resurvey 1951-1963
DCSD 2008 CS 67/25-52

Monument(s) & Accessories Found: (Condition and Source)

GLD BRASS CAP
9" CHINCIPIN N 72° E 27.0 FT Vis. Scribe
7" D. FIR S 75 E 20.0 FT Vis Scribe
19" D. FIR S 48 W 18.4 FT Vis Scribe
31" D. FIR N 70 W 7.3 FT Healed FACE
28" X 2' TALL D. FIR STUMP S 89 E 36.3 FT Mostly Rotten

Monument Detail



Monument Set (Procedures and Description)

New Accessories

Location & Comments

CORNER IS ON
MODERATE WEST SLOPE
APPROX 200' WEST
OF ROAD

Compass Declination 15 1/2
 Firm/Agency: i.e. Engineering, Inc.
 Address: 809 SE Pine St., Roseburg, OR 97470
 Party Chief: N. FROMDAHL
 Notes:
 Witness: R. OLSEN

Surveyor's Seal

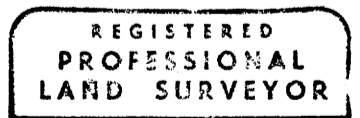

Ronald A. Guimby

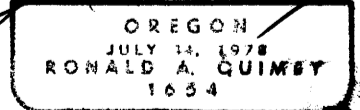

EXP 12-31-16

C.S. File 65/89-3