

GROSSENBACHER 1965 F00406864JB

BT6
COUNTY SURVEYOR'S RECORD
OF
RE-ESTABLISHED GOVERNMENT CORNERS

433

Decl. Compass 17^oE Mo. March 6 Day 2015 Year No. Book Page

Old Monument Powell 1965 Book 53, Pg. 53

Found 2 1/2" brass cap on a 1 1/4" o.d. iron pipe, 0.8' tall, in good condition and solid in the ground, surrounded by a mound of sandstone rocks. We set a White Cedar post 3' North and paint the top in blue. Monument is located 7' West of steep and deep rock bluff. Lat. & Long. per hand held Garmin is 42°54'33.1" and 123°49'10.1"

Old BT Byars 1901 G47, Pg. 014

Found a 33" Douglas Fir burned stump, S32°E, 19.50' to heart center. We find no marks or tags. We paint "BT" and a band around the stump in blue. POOR CONDITION

Old BT Byars 1901 G47, Pg. 014

Found a 28" Douglas Fir remains, N60°W, 32.88' to heart center. We find no marks or tags. We paint the wood ring in blue. POOR

Old BT Powell 1965 Book 53, Pg. 53

Found a 5" Dead Madrone snag with live sprouts at the bottom, S24°30'E, 65.80' to right side center. We find overgrown finishing nails up high, the snag being solid, but burned and hollow. We paint the face and a band around the snag in blue. FAIR CONDITION

Old BT Powell 1965 Book 53, Pg. 53

Found a 22" Chinkapin low cut stump, S45°W, 47.19' to heart center. We find no marks or tags. We paint the top in blue. FAIR

New BO

A 22" Douglas Fir stump, S19°W, 38.52' to a spike and Coos County washer driven in at heart center. We chop an "X" in the face and paint the "X" and the top of the stump in blue and attach a yellow Coos County tag.

New BO

A 17" Douglas Fir stump, S69°30'W, 15.92' to a spike and Coos County washer driven in at heart center. We chop an "X" in the face and paint the "X" and the top of the stump in blue and attach a yellow Coos County tag.

Present:

Matthew Martin
Bill Hales

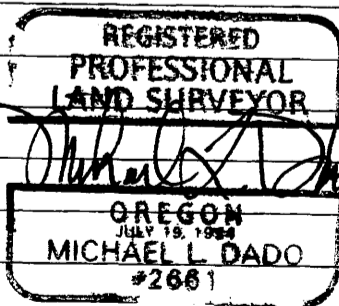

FILED

Date: 4/28/2015 By: JC

This survey consists of:

Map:

Narrative:

Corner Rpt: CS 65/87-57

DOUGLAS COUNTY
SURVEYOR

104100 T309

100700 T319

C.S. FILE

65/87-57