

432

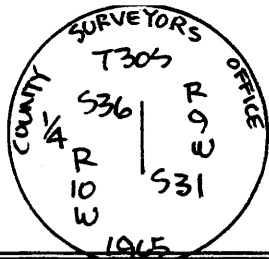

BT6
COUNTY SURVEYOR'S RECORD
OF
RE-ESTABLISHED GOVERNMENT CORNERS

Decl. Compass 17°E Mo. March 5 Day 2015 Year No. Book Page

Old Monument Powell 1965 Book 11, Pg. 89-90

Found 2 1/2" brass cap on an 1 1/4" o.d. x 36" long iron pipe, laying on the ground approx. 4' North of true position, apparently removed during logging operation. We reset the monument based on a distance-distance-distance intersection, now 1.6' tall and solid in the ground, surrounded by a mound of sandstone rocks. We set a Cedar post 3' South and paint the top in blue. Lat. & Long. per Garmin handheld is 42°55'02.3" and 123°49'17.4".

Old BT Hawthorn 1855 G41 Pg. 04

Found a 15" White Cedar tall stump, 5' tall, N37°W, 17.59' to heart center. We find visible scribes in a high chopped out blaze, 0.4' from heart center. There is a 1984 Rex Timber tag in place. We paint the face and a band around the stump in blue. GOOD CONDITION
Note: Hawthorn and Bushey call this tree a Fir.

Old BT Bushey 1893 G41, Pg. 34

Found a 10" White Cedar stump 35' tall, S44°E, 15.74' (S50°E-15.84' var.) to heart center. We find visible scribes, including Jack La Flamme's 378 in an open blaze. We paint the face and a band around the stump in blue. GOOD

Old BT Powell 1965 Book 11, Pg. 89-90

Found a 25" White Cedar stump, 5' tall, N82°W, 12.10' to heart center. We find visible scribes and a Rex Timber tag in place. We paint the face and a band around the stump in blue. GOOD CONDITION

New BO

A 16" Douglas Fir stump, N45°E, 28.48' to a spike and Coos County washer driven in at heart center. We chop an "X" in the face, paint the "X" and the top of the stump in blue and attach a yellow Coos County tag.

New BO

A 15" Douglas Fir stump, S58°E, 15.54' to a spike and Coos County washer driven in at heart center. We chop an "X" in the face, paint the "X" and the top of the stump in blue and attach a yellow Coos County tag.

Present:

Matthew Martini
Bill Hales
Michael L. Dado

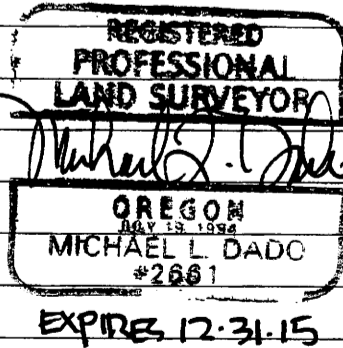

FILED

Date: 4/28/2015 By: JC
This survey consists of:

Map: _____

Narrative: _____

Corner Rpt: CS 65/87-56

DOUGLAS COUNTY SURVEYOR

100140 T3D-9

C.S. FILE 65/87-56