

430

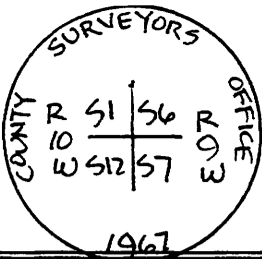

T315

**BT6**  
**COUNTY SURVEYOR'S RECORD**  
 OF  
**RE-ESTABLISHED GOVERNMENT CORNERS**

Decl. Compass 17° Mo. March 3 Day 2015 Year No. Book Page

Old Monument Powell 1967 Book 12, Pg. 06  
 Found 2 1/2" brass cap on an 1 1/4" o.d. iron pipe, 1.0' tall, in good condition and fairly solid in the ground. We build a mound of sandstone rock around the monument and set a Cedar post 2' North and paint the top in blue.

Old BT Byars 1900 G47, Pg. 13  
 Found a 30" Douglas Fir tall stump, 7' tall, S59°W, 9.74' to right side center, 8.34' to face (S55°W - 9.9' rec.). We find a chopped out face with visible scribes and a 1956 BLM tag. We paint the face and "BT" in blue. **FAIR CONDITION**

Old BT Byars 1900 G47, Pg. 13  
 Found a 42" Douglas Fir stump, N25°E, 111.42' to heart center (N20°E - 115.5' rec.). We find visible scribes on a badly decomposed stump. We paint the face and "BT" in blue. **POOR CONDITION**

Old BT Powell 1967 Book 12, Pg. 06  
 Found an 18" White Cedar stump, N44°E, 52.87' to heart center. We find no visible marks. We paint the top in blue. **GOOD CONDITION**

Old BT Powell 1967 Book 12, Pg. 06  
 Found a 15" Hemlock tall stump, 6' tall, S02°W, 28.42' to left side center. We find a healed blaze and a Douglas County tag in place. We paint the face and a band around the stump in blue. **GOOD CONDITION**

Old BT Powell 1967 Book 12, Pg. 06  
 Found a 14" Hemlock stump, S30°W, 25.18' to heart center. We find a healed blaze. We paint the face in blue. **GOOD CONDITION**

New BO  
 A 14" Douglas Fir stump, N40°W, 38.79' to a spike and Coos County washer driven in at heart center. We chop an "X" into the face and paint the "X" and the top in blue. We attach a yellow Coos County tag.

New BO  
 A 12" Douglas Fir stump, N81°E, 24.42' to a spike and Coos County washer driven in at heart center. We chop an "X" into the face and paint the "X" and the top in blue. We attach a yellow Coos County tag.

New BO  
 An 18" Douglas Fir stump, S30°30'E, 21.16' to a spike and Coos County washer driven in at heart center. We chop an "X" into the face and paint the "X" and the top in blue. We attach a yellow Coos County tag.

New BO  
 A 6" Douglas Fir stump, S40°W, 35.84' to a spike and Coos County washer driven in at heart center. We paint the top in blue and attach a yellow Coos County tag.

Present:  
 Matthew Martin  
 Bill Hales

FILED  
 Date: 4-28-2015 By: JC  
 This survey consists of:  
 Map:  
 Narrative:  
 Corner Rpt: CS 65/87-54

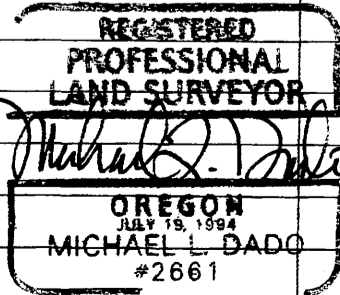

DOUGLAS COUNTY SURVEYOR

100600 T319

EXPIRES 12-31-15

C.S. FILE 65/87-54