

CORNER REPORT FORM

FILED

Section 2  
Douglas County  
PLSS Number  
500900

Township 30S Range 9W  
Date 4-2015

Date: 4-14-2015 By: JC

This survey consists of:

Map: \_\_\_\_\_

Narrative: \_\_\_\_\_

Corner Rpt: CS 65/87-45

DOUGLAS COUNTY  
SURVEYOR

CORNER DESIGNATION

SEC COR 34/35  
3/2

- Condition report only
- Not Found
- Renewed
- Unrecorded
- Surveyed In
- Referenced out

Previous Renewals/Surveys, etc:

DCSO 1959 CS 49/100  
BLM Resurvey 1966

Monument(s) & Accessories Found: (Condition and Source)

DCSO BRASS CAP  
 25" W. FIR N90E 25.1 FEET GOOD SURR  
 24" Cedar S50E 22.8 FEET " "  
 32" W. FIR S51W 4.6 FEET " "  
 23" Cedar N40W 29.0 FEET " "

Monument Detail

Sketch

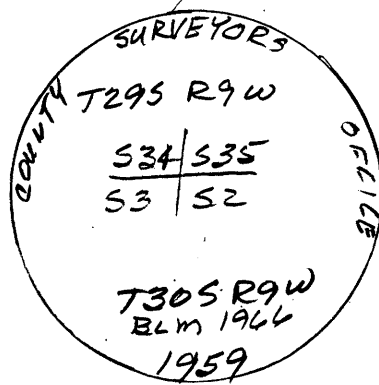

Monument Set (Procedures and Description)

New Accessories

Surveyor's Seal

Location & Comments

HANI Held  
 LAT & LONG.  
 NAD 83  
 N 42° 59.781  
 W 123° 44.529

Compass Declination  
 Firm/Agency: I.e. Engineering, Inc.  
 Address: 809 SE Pine St., Roseburg, OR 97470  
 Party Chief: N Fromdahl  
 Notes:  
 Witness: R. OLSEN

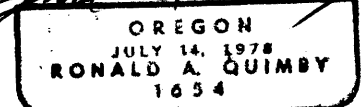

C.S. File

EXP 12-31-16

CS 65/87-45