

CORNER REPORT FORM

FILED

Section 18 Township 3/5 Range 8W
Douglas County Date 2-2015
PLSS Number 200400

Date: 2/24/2015 By: JC
This survey consists of:
Map: _____
Narrative: _____
Corner Rpt: CS 65/87-16
DOUGLAS COUNTY
SURVEYOR

CORNER DESIGNATION

SEC COR 18/17
19/20

- Condition report only
- Not Found
- Renewed
- Unrecorded
- Surveyed In
- Referenced out

Previous Renewals/Surveys, etc:

DCSO 1967
BLM Resurvey 1972
Johnstone 1987 CS 63/26

Monument(s) & Accessories Found: (Condition and Source)

FD DCSO BRASS CAP
38" FIR STUMP N39E 57.4 FT
26" (HIGH STUMP) S66E 9.2 FT
44" (HIGH STUMP) S58W 20.6 FT
7" Hemlock N18E 45.3 FT Vis. Scribe
19" Hemlock S32E 25.9 FT (REC. 22.9) (HIGH STUMP)
14" Hemlock N75W 25.7 Vis Scribes
Monument Detail

Sketch

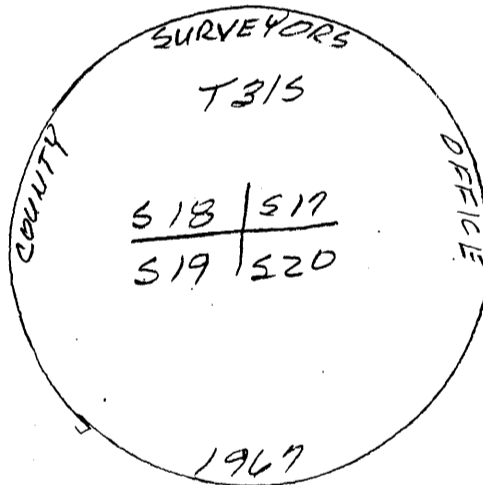

Monument Set (Procedures and Description)

New Accessories

Surveyor's Seal

Location & Comments

Compass Declination 15 1/2
Firm/Agency: i.e. Engineering, Inc.
Address: 809 SE Pine St., Roseburg, OR 97470

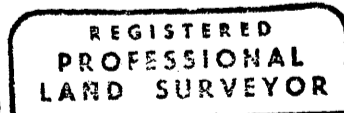

Party Chief: N. Kromdahl
Notes:
Witness: J. LEONARD
R. OLSEN

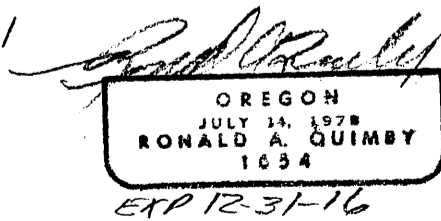

C.S. File CS 65/87-16