

CORNER REPORT FORM

FILED

Section 28 Township T32S Range 8W
Douglas County Date 10-2014
PLSS Number 300300

Date: 10/15/2014 By: JC
This survey consists of:
Map: _____
Narrative: _____
Corner Rpt: CS 65/86-30
DOUGLAS COUNTY
SURVEYOR

CORNER DESIGNATION

sec COR 20/21
29/28

- Condition report only
- Not Found
- Renewed
- Unrecorded
- Surveyed In
- Referenced out

Previous Renewals/Surveys, etc:

BLM 1959
DCSO 1968 CS 54/45
DCSO-GIS 1-2004

Monument(s) & Accessories Found: (Condition and Source)

BLM BRASS CAP
47" FIR N5E 14.4 FT FAINT BARK Scribes
44" FIR S70W 38.3 FT GOOD SCAR
16" CEDAR N138W 56.0 FT Vis Scribes

Monument Detail

Sketch

T32S R8W
520/521
529/528

Monument Set (Procedures and Description)

New Accessories

A 8" FIR S60E 359 FT Scribed T32S R8W 528 BT

Surveyor's Seal

Location & Comments

Compass Declination 15 1/2
Firm/Agency: i.e. Engineering, Inc.
Address: 809 SE Pine St., Roseburg, OR 97470

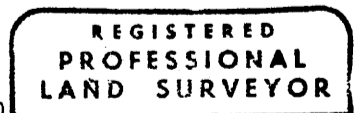

Party Chief: N. Fromm (sk)
Notes:
Witness: D. MARRING
R. OLSEN

Ronald A. Quimby

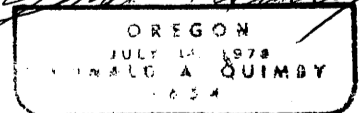

C.S. File CS 65/86-30