

FILED

Date: 9-11-2014 By: X

This survey consists of:

Map: \_\_\_\_\_

Narrative: \_\_\_\_\_

Corner Rpt. CS 65/86-13

### OREGON CORNER RESTORATION FORM

Section **8** Township **25S** Range **01W**

County **Douglas** Date **August 2014**

**DOUGLAS COUNTY SURVEYOR**

Corner Designation **1/4 COR**  
**S5**  

---

**S8**

- Condition Report Only
- Not Found
- Renewed
- Unrecorded
- Surveyed In
- Referenced out

#### Previous Renewals / Surveys, etc.

Original by Hezekiah Johnson in 1900. Corner was remonumented by County in 1966.

#### Monument (s) & Accessories Found: (Condition & Source)

Found 1966 Douglas County brass cap set from original evidence.

Found 32" Cedar bears N79°W 5.90 feet (record N79°W 5.9 feet)

Found 22" Fir bears S11 1/2°E 55.20 feet (record S11°E 55.7 feet)

Found 8 1/2" Chinquapin bears N14 1/2°W 25.00 feet (record N14°W 24.6 feet)

#### Monument Detail

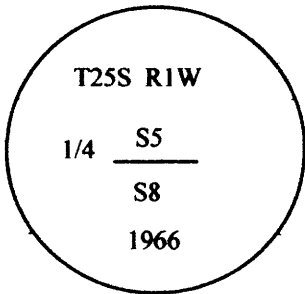

#### Sketch

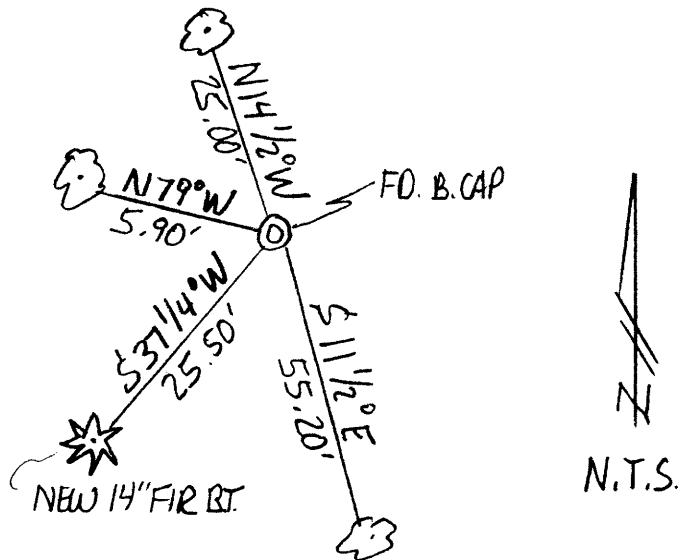

#### Monument Set (Procedures & Description)

N/A

#### New Accessories

14" fir bears S37 1/4°W 25.50 feet scribed "1/4 S8 BT"

NOTE: Bearing is to the center of the tree and distance is measured to a spike in the side of the tree.

#### Location & Comments:

Corner lies on a westerly slope.

Compass Declination N/A

#### Firm/Agency

Gregory D. Lang, Surveyor  
7550 Willis Creek Rd.  
Winston, Or 97496

#### Party Chief and Notes

Gregory Lang

#### Witness

Trevor Lang

#### Surveyor's Seal

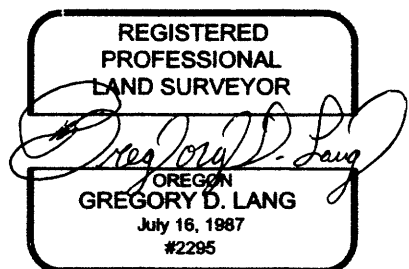

EXPIRES: 12-31-2014

C.S. File No 65/86-13