

USDA-FOREST SERVICE

FILED JUL 2 2014

Index
 File No. P-2 CORNER RECORD (SEARCH) PROJ. NO. ELK CORNER CW 1/16
 TOWNS. 32 S RANGE 1 W R.D. TILLER COUNTY DOUGLAS GCDB# 120340
 MERID. WM FOREST UMPQUA STATE OREGON

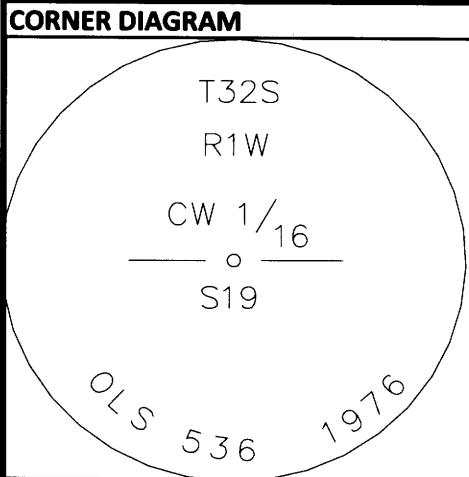

CORNER MONUMENT FOUND
 FOUND 3" BRASS CAP ON 2-1/2" IRON PIPE, FLUSH IN A MOUND OF STONE

DESCRIBE BEARING TREES OR OTHER OFFICIAL ACCESSORIES FOUND

DIA	TYPE	BEARS	DIST	FACE/MARKINGS
22"	FIR	(S5W)	(20.1 FT)	HEALED DOUBLE BLAZE
23"	FIR	(N11W)	(6.4 FT)	HEALED DOUBLE BLAZE

() = RECORD PER 2002 BLM RECORD

Obj. Ident. _____
 Ident. By _____
 Signature _____

DESCRIBE CORNER LOCATION RELATIVE TO NEAR-BY FEATURES, ALSO HOW TO REACH CORNER
 CORNER FALLS ON EDGE OF RECENT PRIVATE CLEAR CUT UNIT AND NEAR HIGHWAY, THERE IS A PRIVATE LOGGING ROAD JUST NORTHEAST OF CORNER ABOUT 100 FT FROM INTERSECTION OF SAID ROAD AND HIGHWAY

PLANE COORDINATE POSITION DATA
 State _____ Zone _____
 North _____
 West _____
 Estab. By _____

Signature _____ Title _____ Division _____ Headquarters _____ Date _____ 7100-52 (3/68)

CORNER RECORD (PERPETUATION)

MONUMENT : DESCRIBE NEW MONUMENT SET, OR WORK DONE TO PRESERVE EXISTING MONUMENT
 BRUSH CLEARED AROUND MONUMENT AND TO BT'S
 "LAND LINE" FLAGGING TIED ON MONUMENT AND GUARD POSTS

REGISTERED PROFESSIONAL LAND SURVEYOR
John Ransom
OREGON
 JULY 21, 1992
 JOHN C. RANSOM
 2561

ACCESSORIES : DESCRIBE NEW BT'S WITNESS OBJECTS ETC. ESTABLISHED, OR WORK DONE TO PRESERVE EXISTING EVIDENCE
 NO NEW ACCESSORIES ADDED
 NEW NAILS IN BT TAGS AND PAINTED FACES & 6 INCH BAND AT HEAD HEIGHT

DONE BY: Jonathan Drew TITLE LSIT DATE 9/10/2013 PLS NO./AGENCY/STATE JOHN RANSOM, PLS2561
 Certified Cor. Record Prepared? NO Filed At: _____ DATE _____

REMARKS
 PROPERTY LINE MAINTINED WEST .25 MILES AND NORTH .25 MILES

Index File No P-2 T. 32 S R. 1 W M. WM Proj No. ELK Cor. CW 1/16

C.S. File No 65/85-24