

Index

CORNER RECORD (SEARCH)

File No. T-10 PROJ. NO. ELK CORNER CW 1/16
 TOWNS. 31 S RANGE 1 W R.D. TILLER COUNTY DOUGLAS GCDB# 320240
 MERID. W.M. FOREST UMPQUA STATE OREGON

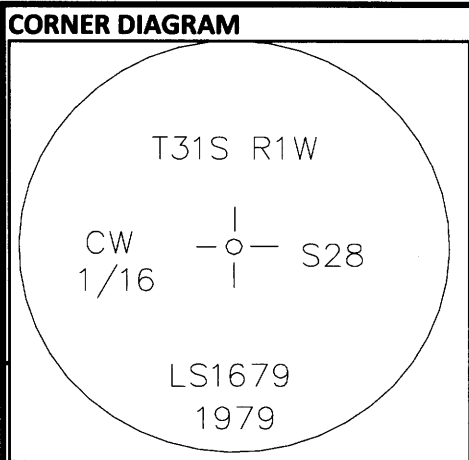

DESCRIBE CORNER MONUMENT FOUND
 FOUND 2-1/2" BRASS CAP ON 2-1/4" IRON PIPE, PROJECTING 4 INCHES ABOVE A MOUND OF STONE

DESCRIBE BEARING TREES OR OTHER OFFICIAL ACCESSORIES FOUND

DIA	TYPE	BEARS	DIST	FACE/MARKINGS
12"	ROOT HOLE	N6°E	14.7 FT	SMALL ROOT HOLE, 12" W.OAK WINDFALL WITH HEALED DOUBLE BLAZE ALONGSIDE
12"	FIR	S88°30'W	10.6 FT	HEALED SINGLE BLAZE

Obj. Ident. _____
 Ident. By _____
 Signature _____

DESCRIBE CORNER LOCATION RELATIVE TO NEAR-BY FEATURES, ALSO HOW TO REACH CORNER
 CORNER FALLS ABOUT 450 FEET EAST OF LINE CROSSING, TAKE 1610-300 ROAD FROM HIGHWAY TO 1610-370 ROAD, FOLLOW 370 ROAD ABOUT 3/4 MILE TO POSTED PROPERTY LINE CROSSING, FOLLOW POSTED/BLAZED PROPERTY LINE EAST TO CORNER.

PLANE COORDINATE POSITION DATA
 State _____ Zone _____
 North _____
 West _____
 Estab. By _____

Signature _____ Title _____ Division _____ Headquarters _____

CORNER RECORD (PERPETUATION)

MONUMENT : DESCRIBE NEW MONUMENT SET, OR WORK DONE TO PRESERVE EXISTING MONUMENT
 BRUSH CLEARED AROUND MONUMENT AND TO BT'S
 "LAND LINE" FLAGGING TIED ON MONUMENT AND GUARD POSTS

REGISTERED PROFESSIONAL LAND SURVEYOR
John Ransom
 OREGON
 JULY 21, 1992
 JOHN C. RANSOM
 2561

ACCESSORIES : DESCRIBE NEW BT'S WITNESS OBJECTS ETC. ESTABLISHED, OR WORK DONE TO PRESERVE EXISTING EVIDENCE
 MARKED: A 12" W.OAK BEARS, N20°15'E - 6.0 FT, SCRIBED "CW1/16S28" "BT" ON A DOUBLE BLAZE, WITH BRASS WASHER MARKED "LS2561" BETWEEN B&T IN LOWER BLAZE.
 RED PAINT APPLIED TO BT FACES AND A 6" BAND AT HEAD HEIGHT, BT'S INCLUDE BT & SURVEY MONUMENT TAGS

DONE BY: Jonathan Drew TITLE LSIT DATE 1/15/2014 PLS NO./AGENCY/STATE _____
 Certified Cor. Record Prepared? YES Filed At: DOUGLAS CO. DATE _____

REMARKS
 MEASUREMENTS TO ACCESSORIES MADE WITH A LEICA 1103+ TOTAL STATION WITH REFLECTORLESS EDM TO ALUMINUM NAIL SET AT SIDE CENTER, BASIS OF BEARING FROM M81-59, BEING S00°09'48"W AS SET USING LINE TREE BLAZE 160 FT SOUTH MARKED AS PART OF THIS LAND LINE MAINTAINCE PROJECT.
 MAINTAINED PROPERTY LINE SOUTH .25 AND WEST .25 MILES

Index File No T-10 T. 31 S R. 1 W M. W.M. Proj No. ELK Cor. CW 1/16

C.S. File No 65/85-14