

FILED JUL 2 2014

USDA-FOREST SERVICE

Index **CORNER RECORD (SEARCH)**
 File No. S-8 PROJ. NO. ELK CORNER NE1/16
 TOWNS. 31 S RANGE 1 W R.D. TILLER COUNTY DOUGLAS GCDB# 260260
 MERID. W.M. FOREST UMPQUA STATE OREGON

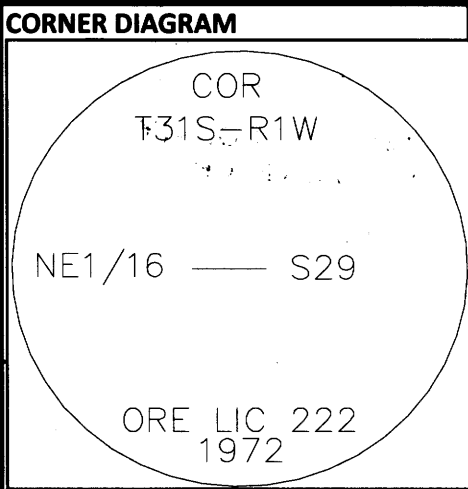

DESCRIBE CORNER MONUMENT FOUND
 FOUND 3 INCH BRASS CAP ON 2-1/2 INCH IRON PIPE, PROJECTING 4 INCHES ABOVE CONCRETE, SURROUNDED BY LARGE STONES

DESCRIBE BEARING TREES OR OTHER OFFICIAL ACCESSORIES FOUND

DIA	TYPE	BEARS	DIST	FACE/MARKINGS
17"	FIR	N37°45'W	26.0 FT	SCRIBE VISIBLE ON LOWER BLAZE, UPPER BLAZE ROTTED AWAY
	FIR	N65°15'W	63.2 FT	HEALED DOUBLE BLAZE, RECORD P.PINE

VERY LITTLE TRACE LEFT OF OTHER TWO ACCESSORIES LISTED IN CS FILE 61/27, ROOTHOLES INDETERMINATE, BOTH PINE'S CALLED IN 61/27 WERE/ARE IN FACT FIR'S

Obj. Ident. _____
 Ident. By _____
 Signature _____

DESCRIBE CORNER LOCATION RELATIVE TO NEAR-BY FEATURES, ALSO HOW TO REACH CORNER
 CORNER LIES ON NORTH SIDE OF FS ROAD 1610-300, WEST OF INTERSECTION WITH UNNAMED ROAD WHICH GOES NORTH TO NORTH SECTION LINE OF SECTION 29, FALLS IN A LARGE POISON OAK PATCH SURROUNDED BY BOULDERS. TAKE 1610-300 TO SAID UNNAMED ROAD, WALK WEST ON 300 RD CORNER ON THE NORTH ABOUT 20 FEET FROM CENTERLINE

PLANE COORDINATE POSITION DATA
 State _____ Zone _____
 North _____
 West _____
 Estab. By _____

Signature _____ Title _____ Division _____ Headquarters _____

CORNER RECORD (PERPETUATION)

MONUMENT : DESCRIBE NEW MONUMENT SET, OR WORK DONE TO PRESERVE EXISTING MONUMENT
 BRUSH CLEARED AROUND MONUMENT AND TO BT'S
 "LAND LINE" FLAGGING TIED ON MONUMENT AND GUARD POSTS

REGISTERED PROFESSIONAL LAND SURVEYOR
John Ransom
 OREGON
 JULY 21, 1992
 JOHN C. RANSOM
 2561

ACCESSORIES : DESCRIBE NEW BT'S WITNESS OBJECTS ETC. ESTABLISHED, OR WORK DONE TO PRESERVE EXISTING EVIDENCE
 MARKED: A 8" FIR BEARS, S31°45'W - 30.8 FT, SCRIBED "NE1/16S29" "BT" ON A DOUBLE BLAZE, WITH BRASS WASHER MARKED "LS2561" BETWEEN B&T IN LOWER BLAZE.
 RED PAINT APPLIED TO BT FACES AND A 6" BAND AT HEAD HEIGHT, BT'S INCLUDE BT & SURVEY MONUMENT TAGS

DONE BY: Jonathan Drew TITLE LSIT DATE 1/15/2014 PLS NO./AGENCY/STATE _____
 Certified Cor. Record Prepared? YES Filed At: DOUGLAS CO. DATE _____

REMARKS
 MEASUREMENTS TO ACCESSORIES MADE WITH A LEICA 1103+ TOTAL STATION WITH REFLECTORLESS EDM TO ALUMINUM NAIL SET AT SIDE CENTER, BASIS OF BEARING FROM M42-70, BEING N00°09'00"E BETWEEN THE NE 1/16 S29 AND THE E 1/16 S29&20, AN OPEN TRAVERSE WAS RUN BETWEEN THESE CORNERS AND CHECKED BY GPS CONTROL, RESULTING IN AN INVERSE OF 1346.17 FEET BETWEEN FOUND CORNERS

Index File No S-8 T. 31 S R. 1 W M. W.M. Proj No. ELK Cor. NE1/16

C.S. File No 65/85-1