

**RECORD OF SURVEY
FOR: OXBOW TIMBER 1 LLC
NW1/4, SECTION 2, T.20 S., R.8 W., W.M.
DOUGLAS COUNTY, OREGON
19 AUGUST 2014**

FILED
DATE: 9/3/2014 BY: NW
THIS SURVEY CONSISTS OF:
MAP: CS 65/84-10
NARRATIVE: _____
CORNER RPT: _____
DOUGLAS COUNTY
SURVEYOR

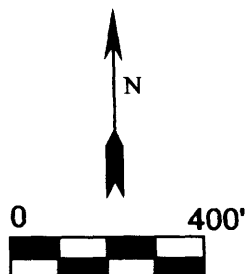

SECTION CORNER SECTIONS 2, 3, 34, 35
FOUND 1952 GLO BRASS CAP WITH THE FOLLOWING ACCESSORIES:
51" D. FIR BEARS S 85° W 20.5' - HEALED FACE
RECORD 18" HEMLOCK BEARING N 37° E - MISSING
RECORD 60" FIR BEARING S 52-1/2° E - DOWN
47" D. FIR BEARS N 38° W 33.0' - HEALED FACE
8" D. FIR BEARS N 69-1/2° W 16.6' - HEALED FACE (2010 BLM TAGGED)
12" D. FIR BEARS N 14-1/4° E 19.6' - HEALED FACE (2010 BLM TAGGED)
STEEL POST ADJACENT TO CORNER

1/4 CORNER SECTIONS 23,26
FOUND 1952 GLO BRASS CAP WITH THE FOLLOWING ACCESSORIES:
24" D. FIR STUMP BEARS N 59° W 33.9' - ROTTED FACE
21" D. FIR STUMP BEARS N 67° E 17.3' - ROTTED FACE
12" D. FIR SNAG BEARS N 49-1/2° W 43.7' - HEALED FACE
9" D. FIR BEARS S 7-3/4° E 7.3' - SCRIBING VISIBLE (2013 BLM TAGGED)
9" D. FIR BEARS N 38-3/4° W 15.3' - SCRIBING VISIBLE (2013 BLM TAGGED)
STEEL POST ADJACENT TO CORNER

LEGEND



FOUND 1/4 CORNER AS NOTED



FOUND SECTION CORNER AS NOTED



BUREAU OF LAND MANAGEMENT
1960 DEPENDENT RESURVEY
RECORD DATA

GLO

GENERAL LAND OFFICE

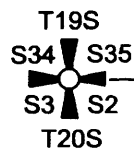

[N 89°04' W 40.00 CHAINS] N 89°04'00" W 2635.33'



NARRATIVE:

THE PURPOSE OF THIS SURVEY IS TO DOCUMENT THE MARKING OF TRUE LINE ON THE WEST HALF OF THE NORTH LINE OF SECTION 2, TOWNSHIP 20 SOUTH, RANGE 8 WEST OF THE WILLAMETTE MERIDIAN.

EXISTING CORNERS WERE TIED BY GROUND TRAVERSE FOR CONTROL AND HELD IN THEIR AS TIED POSITIONS FOR MARKING TRUE LINE. TRUE LINE WAS MARKED WITH RED PAINTED BLAZES, RED FLAGGING AND 5-1/2' GALVANIZED STEEL POSTS SET AT AN AVERAGE INTERVAL OF 200'

THE BASIS OF BEARING FOR THIS SURVEY WAS THE 1960 BUREAU OF LAND MANAGEMENT DEPENDENT RESURVEY OF SECTION 2. TOWNSHIP 20 SOUTH, RANGE 8 WEST OF THE WILLAMETTE MERIDIAN.

THIS SURVEY WAS PERFORMED USING A NIKON TOTAL STATION.

REGISTERED
PROFESSIONAL
LAND SURVEYOR

Ronald L. Rice

OREGON
JULY 9, 2002
RONALD L. RICE
54633LS

EXPIRATION DATE: 12-31-2014

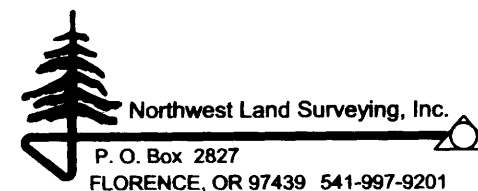

FILE NAME		
14-82		
SCALE	DATE	DRAWN BY
400 Ft/in	8-19-2014	RLR
JOB	REVISION	SHEET
M-WEDGE	---	1/1

This map drawn with TRAVERSE PC Software

C.S. File No 65/84-10