

FILED

Date: 7-8-2014 By: JC

This survey consists of:

Map: _____

Narrative: _____
Corner Rpt: C565/82-53

CORNER REPORT FORM

Section 16 Township 24 S Range 4 W
Douglas County Date 6/25/2014
PLSS Number 400460

DOUGLAS COUNTY
SURVEYOR

CORNER DESIGNATION

North 1/16 Corner to 16/15

- ___ Condition Report only
- ___ Not Found
- X Renewed
- ___ Unrecorded
- ___ Surveyed In
- ___ Referenced out

Previous Renewals/Surveys, etc:

Set by Bentz on M 91-2.
Used by BLM and remonumented with BC in 1979.

Monument(s) & Accessories Found: (Condition and Source)

Found 1979 BLM Brass Cap.
Found 18" diam. Fir with healed blaze N.25 1/4°E., 52.8 feet.
Found 20" Fir stump N.88 1/2°W., 14.9 feet.

Monument Detail

Sketch

Standard BLM Brass Cap

Monument Set (Procedures and Description)

N/A

New Accessories

A 7" diam. Fir scribed "N 1/16 S16 BT" bears S.50°W., 12.8 feet.
A six foot steel post is set 2 feet South

Surveyor's Seal

Location & Comments

Compass Declination 15 1/2° E
Firm/Agency: David A. Edwards
Address: P.O. Box 361
Oakland, OR. 97462
Party Chief: Brant Miller
Notes: _____
Witness: Eric Sprinkle

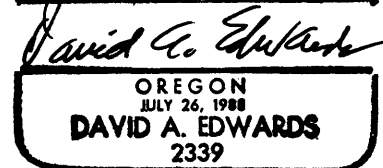
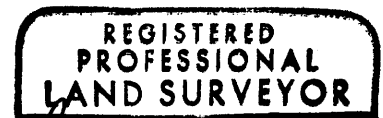

Renews 12/31/15

C.S. File 65/82-53