

CORNER REPORT FORM

FILED

Section 24 Township 30S Range BW
Douglas County Date 5/2014
PLSS Number 600300

Date: 5/27/2014 By: JC

This survey consists of:

Map: _____

Narrative: _____

Corner Rpt: CS 65/82-38

DOUGLAS COUNTY
SURVEYOR

CORNER DESIGNATION

SECCOR. 23/24
26/25

- Condition report only
- Not Found
- Renewed
- Unrecorded
- Surveyed In
- Referenced out

Previous Renewals/Surveys, etc:

R.H.GEE 1955 CS 41/385
1958 CS 49/108
DCSO 1974 CS 56/51
BLM Resurvey 1985

Monument(s) & Accessories Found: (Condition and Source)

DCSO BRASS CAP
46" D FIR N71°E 43 1/2 FT GOOD SCAR
20" D FIR S80°E 19 1/2 FT GOOD SCAR
52" D FIR S22°E 108 1/2 FT GOOD SCAR (Not a snag)
10" D FIR S29°W 9 1/2 FT GOOD SCAR
28" D FIR N45°W 73 1/2 FT GOOD SCAR

Monument Detail

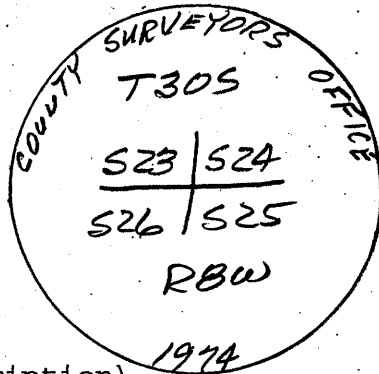

Sketch

Monument Set (Procedures and Description)

New Accessories

Location & Comments

COR IS APPROX
150' EAST OF ROAD
I BOTTOM AREA

Compass Declination 15 1/2

Firm/Agency: I.E.EOG
Address:

Party Chief: J. Leonard

Notes:
Witness: N. Frommhold

Surveyor's Seal

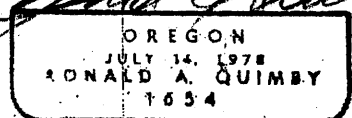
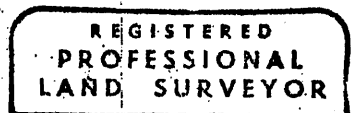

C.S. File 65/82-38