

CORNER REPORT FORM

FILED

Section 30 Township 31S Range 7W  
Douglas County Date 2-2014  
PLSS Number 200300

Date: 2/25/2014 By: JC  
This survey consists of:  
Map:  
Narrative:  
Corner Rpt: C265/82-24

DOUGLAS COUNTY  
SURVEYOR

CORNER DESIGNATION

Sec COR 19/20  
30/29

- Condition report only
- Not Found
- Renewed
- Unrecorded
- Surveyed In
- Referenced out

Previous Renewals/Surveys, etc:

GLO 1882 BLM 1963  
DCSO 3/1970 CS 54/36  
M 139-70 1-2002

Monument(s) & Accessories Found: (Condition and Source)

FD 1963 BLM BRASS CAP

24" D. FIR STUMP	N56°E	38 <sup>3</sup>	GOOD SCAR
12" D. FIR	S89°E	8 <sup>2</sup> FT	GOOD SCAR
27" D. FIR	S76°E	33 <sup>2</sup> FT	GOOD SCAR
8" D. FIR	S37W	17 <sup>2</sup> FT	GOOD SCAR
10" D. FIR (SNAQ TOP)	N19°W	17 <sup>2</sup> FT	GOOD SCAR

Monument Detail

Sketch

Monument Set (Procedures and Description)

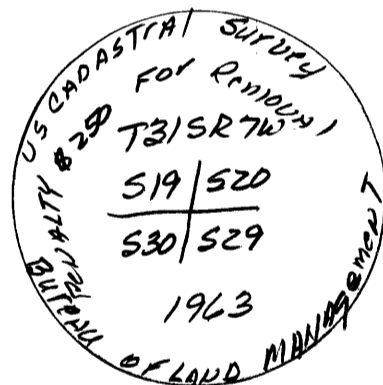

New Accessories

Surveyor's Seal

Location & Comments

Compass Declination 15 1/2°  
Firm/Agency: 10019  
Address:

Party Chief: J. LEONARD  
Notes:  
Witness: N. Fromdahl

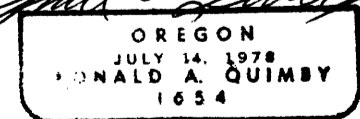
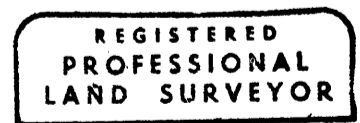

*Donald A. Quimby*

ETP-12-31-14

C.S. File 65/82-24