

Index  
File No. *W-2*

# CORNER RECORD (SEARCH)

Tract or  
Survey No.

Cor.  
No.

T *29S* R *1W* R.D. *TILLER* County *DOUGLAS*

Merid. *Willamete* N.F. *UMPQUA* State *OR*

Corner Diagram

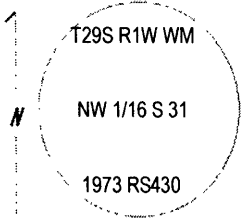

DESCRIBE CORNER MONUMENT FOUND

A 2 1/2 INCH BRASS CAP ON A 2 1/2 INCH IRON PIPE PROJECTING 18 INCHES ABOVE GROUND IN GOOD CONDITION.

DESCRIBE BEARING TREES OR OTHER OFFICIAL ACCESSORIES FOUND

A 20 IN. FIR BRS. N 62° E 16.5 FT. DIST WITH SCIBING VISIBLE ON PHDB

A ROOT HOLE WITH ROTTEN FIR REMAINS BRS. N 74° W 45.0 FT. DIST. NO MARKS

PHOTO I.D. DATA

Photo No.  
Filed At  
Object Ident  
Ident By

Signature

PLANE COORDINATE  
POSITION DATA

DESCRIBE CORNR LOCATION RELATIVE TO NEAR-BY FEATURES, ALSO HOW TO REACH CORNER

CORNER LIES ON A GENTLE SOUTH SLOPE APROXIMATLY 200 FT. EAST OF ROAD 2810

State Zone

X

Y

Estab. By

Agency

Signature

*LANCE GOUCHER*

Title

*Survey Tech.*

Division

Headquarters

*Medford*

Date

*5/ 2011*

FS-7100-52 (3/68)

CORNER RECORD (PERPETUATION)

MONUMENT: DESCRIBE NEW MONUMENT SET, OR WORK DONE TO PRESERVE EXISTING MONUMENT

Painted bearing trees, nailed signs and tags and cleared brush around corner

ACCESSORIES: DESCRIBE NEW BT'S, WITNESS OBJECTS, ETC. ESTABLISHED, OR WORK DONE TO PRESERVE EXISTING EVIDENCE MARKED A NEW BT:

A 10 IN. P. PINE BRS. N 75 1/4 ° W. 23.1 FT DIST. MARKED NW1/16S31BT ON A DOUBLE BLAZE WITH A WASHER STAMPED LS2561 ON THE LOWER FACE

**FILED**

Date *11/18/2013* By *sc*

This survey consists of:

Map: \_\_\_\_\_

Notes: \_\_\_\_\_

Corner File *CS 65/80-53*

DOUGLAS COUNTY  
SURVEYOR

REGISTERED  
PROFESSIONAL  
LAND SURVEYOR

*John Ransom*

OREGON  
3.13.21.1992  
JOHN C. RANSOM  
2561

C.S. File No *65/80-53*