

Index  
File No. Z-2

### CORNER RECORD (SEARCH)

Tract or  
Survey No.

Cor.  
No.

T 29S R 1W R.D. TILLER County DOUGLAS

Merid. Willamette N.F. UMPQUA State OR

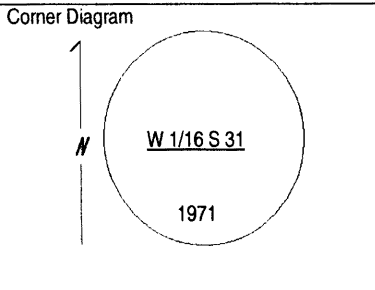

DESCRIBE CORNER MONUMENT FOUND  
A 3 1/2 INCH BLM BRASS CAP ON A 2 1/2 INCH IRON PIPE PROJECTING 7 INCHES ABOVE GROUND IN GOOD CONDITION.

DESCRIBE BEARING TREES OR OTHER OFFICIAL ACCESSORIES FOUND  
A 14 IN. YEW BRS. N 17 1/2° E 21.5 FT. DIST WITH SCRIBING VISIBLE ON A PHDB  
A 14 IN. FIR SNAG BRS. S 40° E 9.6 FT. DIST. WITH A HEALED BLAZE (NO RECORD)  
INDT. FIR N 70-1/2° E 65.5 FT., INDETERMINATE ROOT HOLE WITH ROTTEN LOG LAYING ALONGSIDE, NO MARKS

PHOTO I.D. DATA  
Photo No.  
Filed At  
Object Ident  
Ident By

Signature  
PLANE COORDINATE  
POSITION DATA  
State Zone  
X  
Y  
Estab. By  
Agency

DESCRIBE CORNR LOCATION RELATIVE TO NEAR-BY FEATURES, ALSO HOW TO REACH CORNER  
CORNER LIES ON A MODERATE EAST SLOPE APROXIMATLEY 1500 FEET SE OF THE JUNCTION OF ROAD 2800 AND ROAD 2800-310

Signature LANCE GOUCHER Title Survey Tech. Division \_\_\_\_\_ Headquarters Medford Date 5/ 2011 FS-7100-52 (3/68)

### CORNER RECORD (PERPETUATION)

MONUMENT: DESCRIBE NEW MONUMENT SET, OR WORK DONE TO PRESERVE EXISTING MONUMENT  
Painted bearing trees, nailed signs and tags and cleared brush around corner

ACCESSORIES: DESCRIBE NEW BT'S, WITNESS OBJECTS, ETC. ESTABLISHED, OR WORK DONE TO PRESERVE EXISTING EVIDENCE  
MARKED A NEW BT:  
A 10 IN. FIR BRS. N 55 1/2° W. 17.2 FT DIST. MARKED W1/16S31BT ON A DOUBLE BLAZE WITH A WASHER STAMPED LS2561 ON THE LOWER FACE

**FILED**

Date: 11-18-2013 By: JC  
This survey consists of:  
Map: \_\_\_\_\_  
Narrative: \_\_\_\_\_  
Corner Rpt: CS 65/80-51

**DOUGLAS COUNTY  
SURVEYOR**

REGISTERED  
PROFESSIONAL  
LAND SURVEYOR  
John Ransom  
OREGON  
JUL 21 1997  
JOHN C. RANSOM  
2561

C.S. File No 65/80-51