

FILED

Date: 10/30/2013 By: JC

This survey consists of:

Map: \_\_\_\_\_

Narrative: \_\_\_\_\_

Corner Rpt: CS 65/80-34 - 4895

DOUGLAS COUNTY  
SURVEYOR

CERTIFIED RECORD OF LAND CORNER MONUMENTATION

**History of original corner establishment:** Angle Point 1138, Oregon Cascade Recreation Area

The Forest Service established this corner for the OCRA in 1990. They set an iron pipe, 2-3/8" outside diameter, 30" long, 20" in the ground with a 4 foot diameter mound of stone to the top, with a 2-1/2" diameter brass cap attached and marked as shown.

They marked BTs: a 10" red fir, bears S. 53° E., 25.6 feet, scribed "OCRA H BT" on a single blaze; and a 5" lodgepole pine, bears N. 11° W., 14.7 feet, scribed "OCRA H BT" on a single blaze.

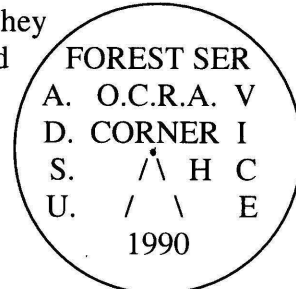

**Description of corner evidence found:** September 26, 2013

I found a 2-3/8 inch diameter iron pipe, firmly set, projecting 4-inches Above a 4-foot diameter mound of stone, with a 2-1/2 inch diameter brass cap attached marked as shown:

From which the remains of bearing trees established in 1990:

- A 13" red fir, bears S. 53° E., 25.3 feet (rec. 25.6 ft.), with a healed blaze.
- a roothole, bears N. 11° W., 14.7 feet, with decayed lodgepole pine log alongside with scribe "OCRA H BT" visible on an unhealed blaze.

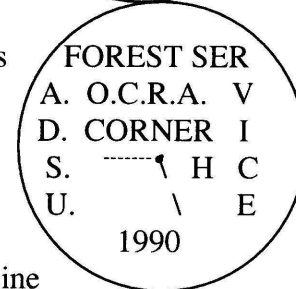

**Description of monument and accessories I established to perpetuate the original location of this corner:** September 26, 2013

And from which I add new references:

- An 8" diameter noble fir, bears N. 62-3/4° E., 25.1 feet, scribed "OCRA AP 1138 BT" on a single blaze.
- An 18" diameter noble fir, bears S. 85-1/2° W., 31.3 feet, scribed "OCRA AP 1138 BT" on a single blaze. This is the left trunk of a double trunked tree. Measurements are to the common rootcrown.
- A 6-foot aluminum post driven 1.5 feet in the ground, bears N. 61-3/4° E., 1.7 feet, with Forest Service "Land Survey Monument" sign attached as a guard post.

With a 20 second optical transit I sighted on the original SE BT with a bearing of S. 53° E. as my basis of bearings. Bearings are measured to the nearest 1/4°. Trees are measured to the center of the root crown. Tree diameters are at breast height. New bearing trees have a 3/4" brass washer, pre-marked "LS 2150", nailed to the BT portion of the blaze.

Witness: Robert Lee

Leonard E. Herzstein, L.S. 2150  
Umpqua National Forest  
2900 NW Stewart Parkway  
Roseburg, OR 97471

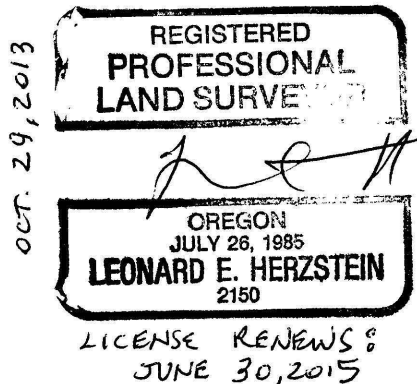

AP 1138

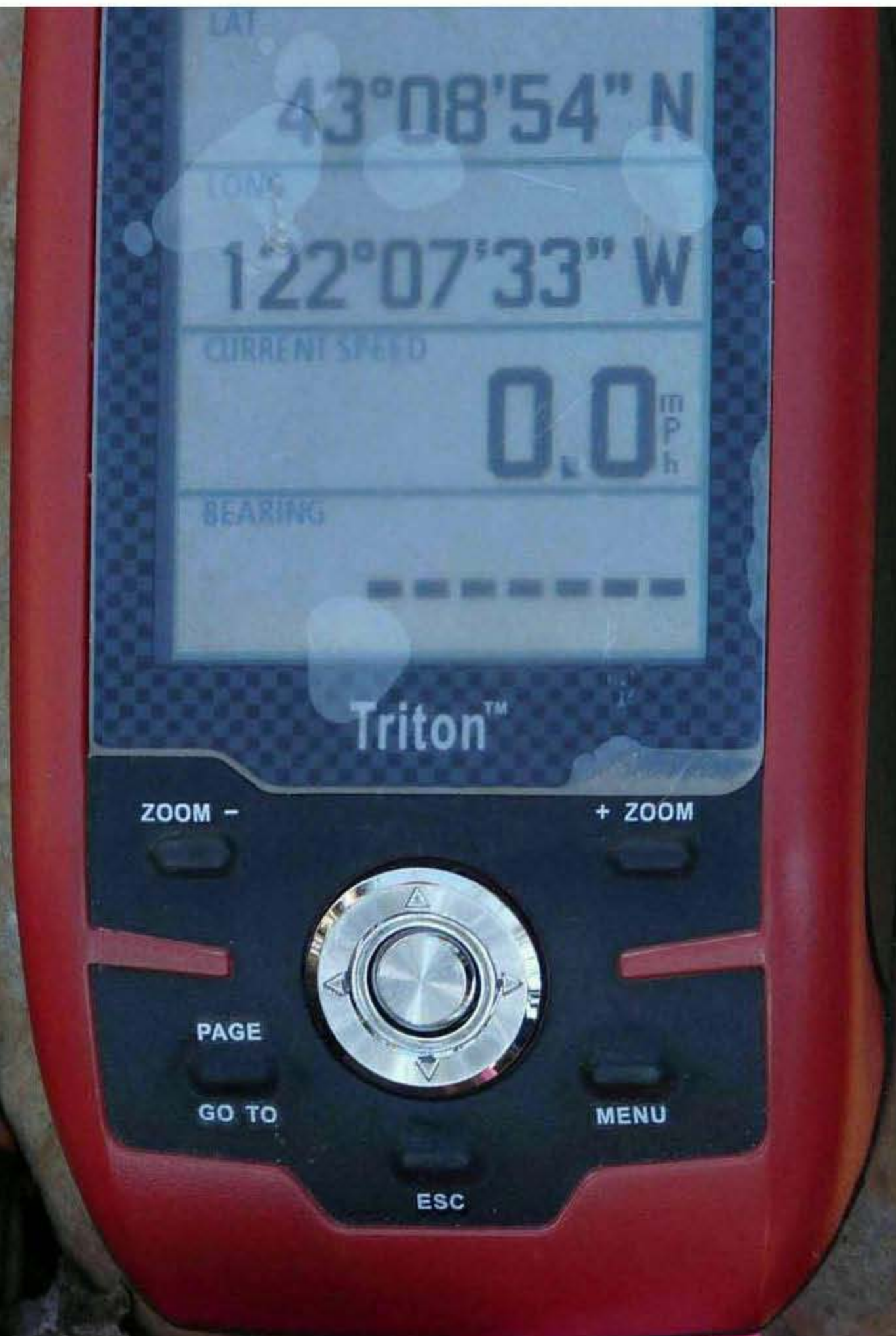

AP 1138  
NEW SW BT



APPROX 1" = 1000'

LAT: 43°08'54"N  
LONG: 122°07'33"W

APPROX  
LOCATION  
AP 1138  
OCRA

05VE17

2805VE16

DIAMOND  
LAKE

5VE20

2805VE21

HWY 138

HWY 230