

FILED

Date: 8/12/2013 By: SC

This survey consists of:
Map: CS 65/79-12A

Narrative: _____
Corner Rpt: CS 65/79-12

B-G

OREGON CORNER RESTORATION FORM

Section 12 Township 30S Range 3W

County Douglas Date 7-29-2013

DOUGLAS COUNTY
SURVEYOR

Corner Designation 1/4 COR
S12
S13

- Condition Report Only
- Not Found
- Renewed
- Unrecorded
- Surveyed In
- Referenced out

Previous Renewals / Surveys, etc.

Original by Bushey in 1893. Original found by County Surveyor in 1963 and a brass cap was set.

Monument (s) & Accessories Found: (Condition & Source)

Found brass cap set in 1963; Found original Fir stump 17.20' to the Southeast and the 1963 Fir snag 6.90' to the Southwest.

Monument Detail

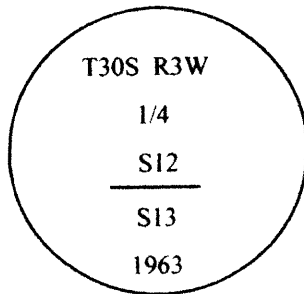

Sketch

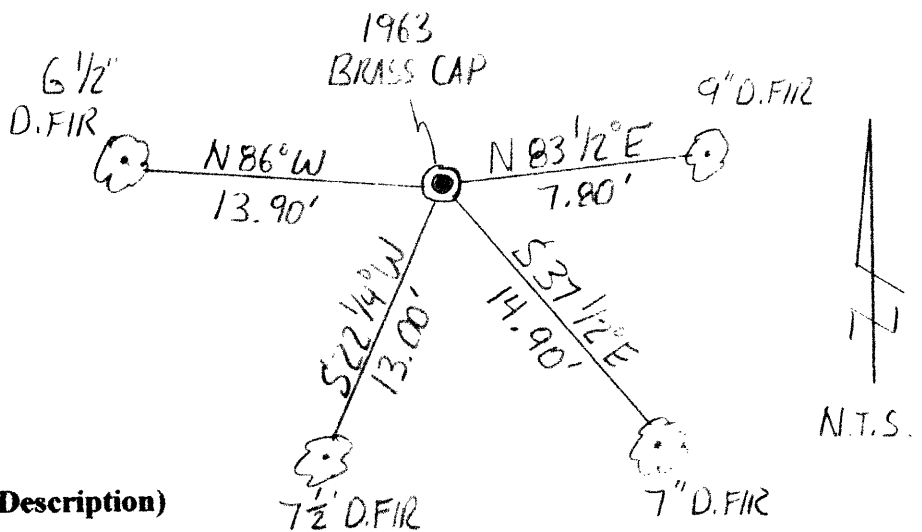

Monument Set (Procedures & Description)

N/A

New Accessories

New BT's

- 6 1/2" D. Fir bears N86°W 13.90' scribed "1/4 S12 BT"
- 9" D. Fir bears N83 1/2°E 7.80' scribed "1/4 S12 BT"
- 7 1/2" D. Fir bears S22 1/4°W 13.00' scribed "1/4 S13 BT"
- 7" D. Fir bears S37 1/2°E 14.90' scribed "1/4 S13 BT"

NOTE: Bearings are to the center of the trees and distances are measured to a spike in the side of the trees.

Location & Comments:

Corner lies on the northerly side of a small ridge, 150'+/- above a gravel road.

Compass Declination N/A

Firm/Agency

Gregory D. Lang, Surveyor
7550 Willis Creek Rd.
Winston, Or 97496

Party Chief and Notes

Gregory Lang

Witness

Trevor Lang

Surveyor's Seal



EXPIRES: 12-31-2014

C.S. File No 65/79-12D