

FILED

Date: 6/13/2013 By: JC

This survey consists of:

Map: \_\_\_\_\_

Narrative: \_\_\_\_\_

Corner Rpt: CS 65/78-52

### OREGON CORNER RESTORATION FORM

Section 20 Township 30S Range 7W

County Douglas Date 6-11-2013

DOUGLAS COUNTY  
SURVEYOR

Corner Designation

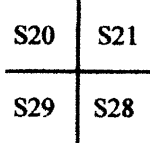

- Condition Report Only
- Not Found
- Renewed
- Unrecorded
- Surveyed In
- Referenced out

#### Previous Renewals / Surveys, etc.

Original by Byars in 1882. Original found by County Surveyor in 1965 and a brass cap was set. Found and used by BLM in 1972. Found by Mark Smalley in 1993.

#### Monument (s) & Accessories Found: (Condition & Source)

Found Brass Cap set in 1965

Found now 40" Fir (record N69°W 22.4' to face) Note: I set a spike at 23.70' in center and side of tree.

Found now 16" D. Fir (record N45°W 41.50')

Also found a stump to the SE, a snag to the NE, and a stump to the SW per the 1965 renewal.

#### Monument Detail

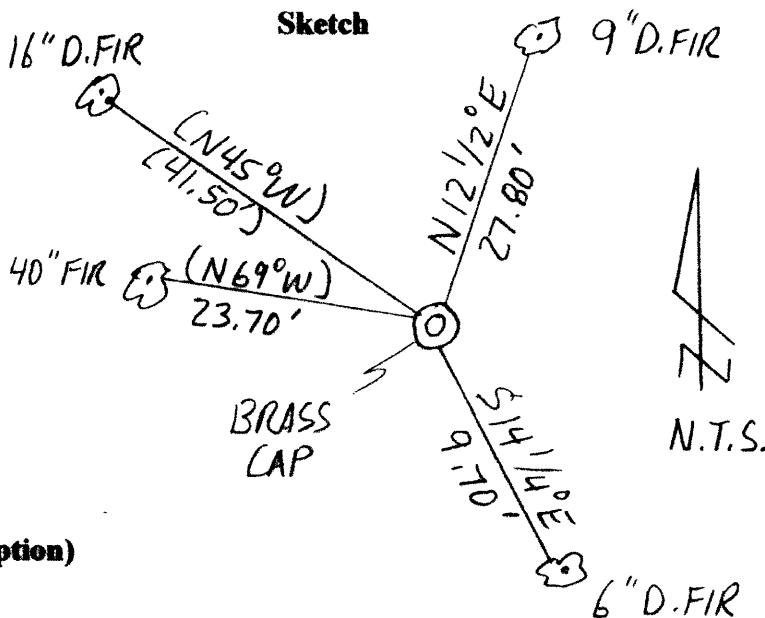
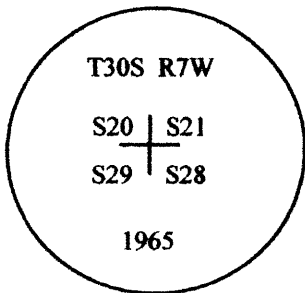

#### Monument Set (Procedures & Description)

N/A

#### New Accessories

New BT's

9" D. Fir bears N12 1/2°E 27.80' scribed "S21 BT"

6" D. Fir bears S14 1/4°E 9.70' scribed "S28 BT"

NOTE: Bearings are to the center of the trees and distances are measured to a spike in side of the trees.

#### Location & Comments:

Corner lies approximately 30 feet East of a small creek.

Compass Declination N/A

#### Firm/Agency

Gregory D. Lang, Surveyor  
7550 Willis Creek Rd.  
Winston, Or 97496

#### Party Chief and Notes

Gregory Lang

#### Witness

Trevor Lang

#### Surveyor's Seal

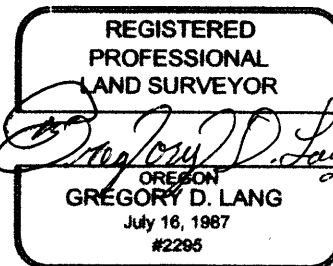

EXPIRES: 12-31-2014