

OREGON CORNER RESTORATION FORM

Section 6 Township 31 S. Range 4W  
 County Douglas Date 2/14/13

FILED  
 Date: 3/13/2013 By: X  
 This survey consists of:  
 Map: \_\_\_\_\_  
 Narrative: \_\_\_\_\_  
 Corner Rpt: CS 65/78-11

Corner Designation

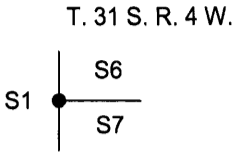

- \_\_\_\_\_ Condition Report Only
- \_\_\_\_\_ Not Found
- \_\_\_\_\_ X \_\_\_\_\_ Renewed
- \_\_\_\_\_ Unrecorded
- \_\_\_\_\_ Surveyed In
- \_\_\_\_\_ Referenced Out

DOUGLAS COUNTY  
 SURVEYOR

Previous Renewals/Surveys, etc.

Original GLO Field Notes Filed in Douglas County Surveyors Office Vol. 19 Pg. 7873, 1959 Markham  
Survey Perpetuated Section Corner From Original BT C. S. File 42/391, C.S. File 54/20,  
BLM Survey Sept 1972 / June 1973 File in Douglas County Surveyors Office Vol. 38 Pg. 15651, Hoffine Map M. 123-69

Accessories Found: (Condition and Source)

28" Douglas Fir Bears N0 3/4°W 16.9 Ft. (Record From M 123-69 N1°E 17.2 Ft.) Healed Face And Tag  
 \_\_\_\_\_  
 \_\_\_\_\_  
 \_\_\_\_\_

Monument Detail

Sketch

1" STEEL DRILL ROD

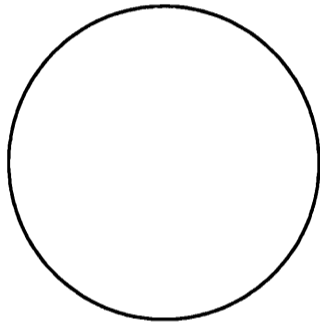

Legend:

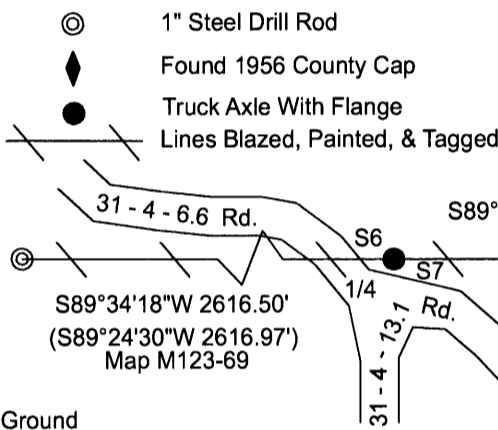

Monument Found

Found 1" Steel Drill Rod 1.5 Ft. Above Ground

New Accessories

14" Douglas Fir Bears N86°W 40.0 Ft. We Scribe BT and Tag Tree  
22" Douglas Fir Bears N55 1/4°W 48.2 Ft. We Scribe BT and Tag Tree  
14" Douglas Fir Bears S5°E 19.4 Ft. We Scribe BT and Tag Tree

Location & Comments

Lone Rock Timber ran a random traverse along the section lines from the east 1/4 corner to the southeast corner to the south 1/4 to the southwest corner of section 6. to mark property lines for timber management purposes. We also ran a GPS survey for survey control at points on our conventional traverse to check closure. We marked the property lines with flagging, blazing, painting, and aluminum tags.  
Found 1" steel drill rod 1.5 feet above ground on southwest slope.

Bearing Basis Bearing is From GPS Observation  
 Firm/Agency Lone Rock Timber Co.  
 Address P. O. Box 1127  
Roseburg, Ore. 97470  
 Party Chief Ken W. Hoffine  
 Notes G. Angiolet  
 Witness G. Angiolet

REGISTERED  
 PROFESSIONAL  
 LAND SURVEYOR

*Ken W. Hoffine*  
 OREGON  
 JULY 16, 1987  
 KEN W. HOFFINE  
 PLS 2291

EXPIRES 6-30-13

C.S. File No 65/78-11