

OREGON CORNER RESTORATION FORM

FILED

Date: 9-18-2012 By: JC

This survey consists of:

Map: _____

Narrative: _____

Corner Rpt: CS 65/77-40

Section 5 Township 21 South, Range 7 West

County Douglas

Date 9-12-2012

DOUGLAS COUNTY
SURVEYOR

Corner Description

NW Section 5

___ Condition Report Only

___ Not Found

X Renewed

___ Unrecorded

___ Surveyed In

___ Referenced Out

Previous Renewals / Surveys, etc.

Monument (s) & Accessories Found: (Condition and Source)

Found: 2 1/2" alum. pipe, protruding 6" above ground with standard International Paper Co. 3/4" alum. cap mkd. "T20S R7W S32 S6 S5 T21S R7W 1983 PLS 1137".

16" D. Fir bears N.3°E., 33.7 ft. scribed T20S R7W S32 BT.
(Found 26" D. Fir with healed face)

17" Chinquapin bears S.32°W., 5.8 ft. scribed T21S R7W S6 BT.
(Found 23" Chinquapin with healed face)

18" D. Fir bears S.25°E., 43.6 ft. scribed T21S R7W S5 BT.
(Found 27" D. Fir with healed face)

Monument Detail

Sketch

Monument Set (Procedures and Description)

None

New Accessories

15" Chinquapin bears S70°E., 6.3 ft, scribed T21S R7W S5 BT

Location & Comments

Corner has steel post adjacent to it.

All BT's have red painted bands and yellow tags.

Compass Declination 16° East

Firm/Agency Northwest Land Surveying Inc.

Address P.O. Box 2827
Florence, OR 97439

Party Chief Ron Rice

Notes _____

Witness Jason Collver

Surveyor's Seal

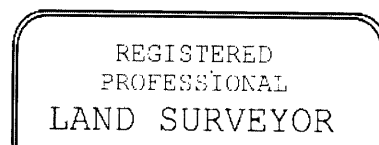

Ronald L. Rice

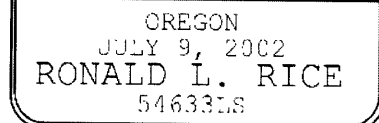

RENEWS: 12-31-2012

C.S. FILE 65/77-40