

FILED

OREGON CORNER RESTORATION FORM

Date: 5/15/2012 By: SC

This survey consists of:

Map: _____

Narrative: _____

Corner Rpt: CS 65/76-55

Section 13 Township 22 South, Range 9 West

County Douglas

Date 14 May 2012

DOUGLAS COUNTY
SURVEYOR

Corner Description

SW Corner

Section 13

Condition Report Only

Not Found

Renewed

Unrecorded

Surveyed In

Referenced Out

Previous Renewals / Surveys, etc.

Monument (s) & Accessories Found: (Condition and Source)

Found 3-1/4" BLM brass cap on iron pipe, dated 1973

A fir, 22 ins. diam., bears N. 77° E., 84 lks. dist., with healed blaze.

(Found a 32" diam. Fir with a healed face)

A maple stump, 11 ins. diam., bears S. 44° E., 35 lks. dist., with fragmentary scribe marks visible on partially healed blaze.

(Found in same condition)

A fir, 17 ins. diam., bears S. 89° W., 62 lks. dist., with healed blaze.

(Found a 23" diam. Fir with a healed face)

A fir, 16 ins. diam., bears N. 58° W., 50 lks. dist., with healed blaze.

(Found a 17" diam. Fir with a healed face)

A fir, 11 ins. diam., bears S. 17½° E., 39½ lks. dist., mkd. T22S R9W S24 BT.

(Found a 18" diam. Fir with a healed face)

Monument Detail

Sketch

Monument Set (Procedures and Description)

None

New Accessories

None

Location & Comments

Corner has steel post _____ Compass Declination 16° East

adjacent to it. _____ Firm/Agency Northwest Land

All BT's have red painted _____ Surveying Inc.

bands and yellow tags. _____ Address P.O. Box 2827
_____ Florence, OR 97439

_____ Party Chief Ron Rice

_____ Notes _____

_____ Witness Jason Collver

Surveyor's Seal

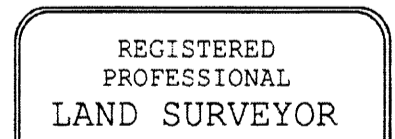

Ronald L. Rice

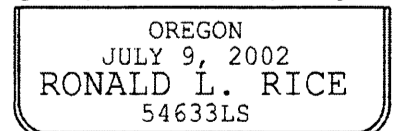

RENEWS: 12-31-2012

C.S. File 65/76-55