

OREGON CORNER RESTORATION FORM

FILED  
Date: 5/2/2012 By: JC  
This survey consists of:  
Map: \_\_\_\_\_  
Narrative: \_\_\_\_\_  
Corner Rpt: CS 65/76-50

Section 36 Township 19 South, Range 9 West  
County Douglas Date 1 May 2012

DOUGLAS COUNTY  
SURVEYOR

Corner Description

S 1/4

Section 36

- Condition Report Only
- Not Found
- Renewed
- Unrecorded
- Surveyed In
- Referenced Out

Previous Renewals / Surveys, etc.

Monument (s) & Accessories Found: (Condition and Source)

Found 2-1/2" G.L.O. brass cap on iron pipe, dated 1953

- A Fir 36" dia., bears S.37°E., 12 lks. dist., mkd. 1/4 S BT on bark blaze.  
(Found 46" Fir with no marks)
- A Cedar 8" dia., bears N.26-1/2°E., 11 lks. dist. mkd. 1/4 S36 BT.  
(Found 24" Cedar with healed face)
- A Fir 50" dia., bears N.56°W., 78 lks. dist. mkd. 1/4 S36 BT.  
(Found 50" Fir stump with healed face)

Monument Detail

Sketch

Monument Set (Procedures and Description)

None

New Accessories

11" D. Fir bearing N 40° W 22.0 ft. blazed, scribed, 1/4 S36 BT

Location & Comments

Corner has steel post \_\_\_\_\_ Compass Declination 16° East  
 adjacent to it. \_\_\_\_\_ Firm/Agency Northwest Land  
All BT's have red painted \_\_\_\_\_ Surveying Inc.  
bands and yellow tags. \_\_\_\_\_ Address P.O. Box 2827  
 \_\_\_\_\_ Florence, OR 97439  
 \_\_\_\_\_ Party Chief Ron Rice  
 \_\_\_\_\_ Notes \_\_\_\_\_  
 \_\_\_\_\_ Witness Jason Collver

Surveyor's Seal

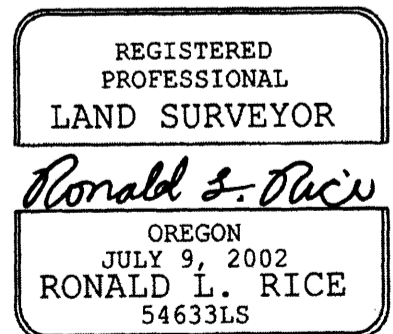

RENEWS: 12-31-2012

C.S. File No 65/76-50